

## Product advantages of the three piece rose system



The solid mounting plate with 7mm fixing lugs ① provides an easy assembly base. Male/Female M4 fixing bolts ② ensure a robust bolt through connection.



The sprung loaded hard wearing inner plate ③ holds the lever handle and allows quick assembly of the inner rose. The modular design accommodates all the lever shapes. Projecting lugs ④ give an accurate assembly and ensure that the fittings are aligned correctly.



The threaded rose ⑤ is screwed over the whole assembly offering a secure, safe and precise fitting. This rose can be unscrewed when required but will not work loose in normal use.

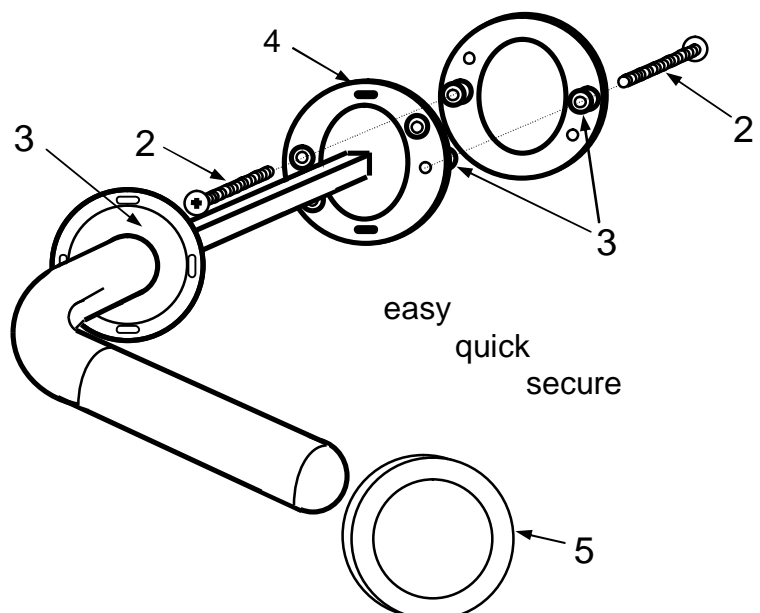

**KARCHER**  
**DESIGN**