

TIOMOS 95

95° hinge (door thicknesses up to 28 mm)

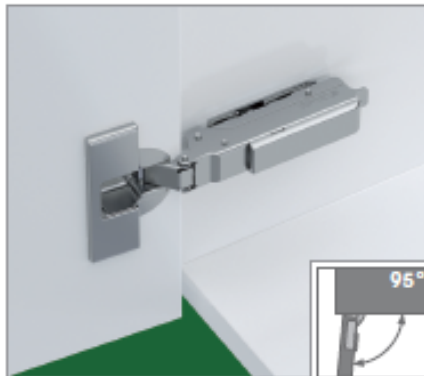

- 95° opening angle
- Optimum reveals up to 28 mm door thickness
- Convenient depth adjustment via worm gear
- 3-dimensional adjustment with appropriate mounting plate

Available in 3 versions:

- With integrated damper (3 adjustable damping levels)
- Without integrated damper
- Without self-closing mechanism (without spring)

ORDER INFORMATION FOR DRILLING PATTERN 45/9.5

Door overlay	Cranking	Damper			Item No. ³		
		with	without	without spring	Click-on For screw fixing	Click-on For press fitting	Impresso without tools
Full overlay ¹	0	■	-	-	F028138567	F028138571	F017139353
		-	■	-	F045138505	F045138509	F034139324
		-	■	■	F046138627	-	F035139381
Overlay ¹	3	■	-	-	F028138568	F028138572	F017139354
		-	■	-	F045138506	F045138510	F034139325
		-	■	■	F046138628	-	F035139382
Half overlay ²	9.5	■	-	-	F028138569	F028138573	F017139355
		-	■	-	F045138507	F045138511	F034139326
		-	■	■	F046138629	-	F035139383
Inset ³	19	■	-	-	F028138570	F028138574	F017139356
		-	■	-	F045138508	F045138512	F034139327
		-	■	■	F046138630	-	F035139384

¹ Cup material: steel, nickel-plated / Arm material: steel, nickel-plated

² Cup material: steel, nickel-plated / Arm material: Zamak, nickel-plated

³ Available on request

COVER CAPS

	Designation	Cranking	Imprinted/Embossed	Item No.
	Hinge arm cover cap, steel, nickel-plated, not imprinted	0/3/9.5/19	On request	F072135500
	Hinge arm cover cap, steel, long, nickel-plated, not imprinted	0/3	On request	F072135504
	Hinge cup cover cap, steel, nickel-plated, not imprinted	0/3/9.5/19	-	F072135503

ACCESSORIES

	Designation	Item No.		Designation	Item No.
	Tipmatic Pin for wooden and aluminium frame doors	F069068873			
	Countersunk wood screw Ø 3.5 x 15 mm	F146073976			

TIOMOS 110

110° hinge (door thicknesses up to 24 mm)

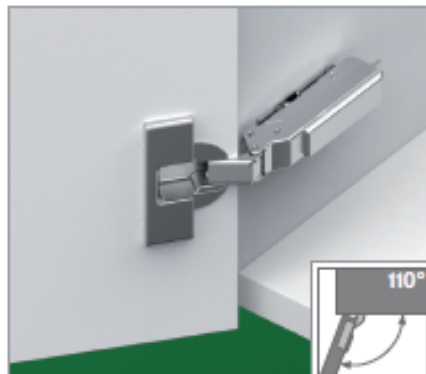

- 110° opening angle
- Optimum reveals for door thicknesses up to 24 mm
- Convenient depth adjustment via worm gear
- 3-dimensional adjustment with appropriate mounting plate

Available in 3 versions:

- With integrated damper (3 adjustable damping levels)
- Without integrated damper
- Without self-closing mechanism (without spring)

ORDER INFORMATION FOR DRILLING PATTERN 45/9.5

Door overlay	Cranking	Damper			Item No.		
		with	without	without spring	Click-on For screw fixing	Click-on For press fitting	Impresso without tools
Full overlay ¹	0	■	-	-	F028138519	F028138523	F017139329
		-	■	-	F045138457	F045138461	F034139300
		-	■	■	F046138579	-	F035139357
Overlay ¹	3	■	-	-	F028138520	F028138524	F017139330
		-	■	-	F045138458	F045138462	F034139301
		-	■	■	F046138580	-	F035139358
Half overlay ²	9.5	■	-	-	F028138521	F028138525	F017139331
		-	■	-	F045138459	F045138463	F034139302
		-	■	■	F046138581	-	F035139359
Inset ²	19	■	-	-	F028138522	F028138526	F017139332
		-	■	-	F045138460	F045138464	F034139303
		-	■	■	F046138582	-	F035139360

¹ Cup material: steel, nickel-plated / Arm material: steel, nickel-plated

² Cup material: steel, nickel-plated / Arm material: Zamak, nickel-plated

COVER CAPS

	Designation	Cranking	Imprinted/Embossed	Item No.
	Hinge arm cover cap, steel, nickel-plated, not imprinted	0/3/9.5/19	On request	F072135500
	Hinge arm cover cap, steel, long, nickel-plated, not imprinted	0/3	On request	F072135504
	Hinge cup cover cap, steel, nickel-plated, not imprinted	0/3/9.5/19	-	F072135503

ACCESSORIES

	Designation	Item No.		Designation	Item No.
	85° opening angle reduction clip	F072135751		Countersunk wood screw Ø 3.5 x 15 mm	F146073976
	Tipmatic Pin for wooden and aluminium frame doors	F069068873			

INSTALLATION INFORMATION

All dimensions in millimetres

Full overlay	K0	Overlay	K3	Half overlay	K9.5	Inset ¹																																																																																																																																																																																																																																																																																																																																																																																																
<p>Mounting plate height 2</p>		<p>Mounting plate height 2</p>		<p>Mounting plate height 2</p>		<p>Mounting plate height 2</p> <p>¹ Set mounting plate back by door thickness +1.5 mm</p>																																																																																																																																																																																																																																																																																																																																																																																																
<table border="1"> <thead> <tr> <th rowspan="2">Door overlay</th> <th colspan="5">Cup distance</th> <th rowspan="2">Mounting plate height</th> </tr> <tr> <th>3</th> <th>4</th> <th>5</th> <th>6</th> <th>7</th> </tr> </thead> <tbody> <tr><td>22.0</td><td></td><td></td><td></td><td></td><td>0</td><td></td></tr> <tr><td>21.0</td><td></td><td></td><td></td><td>0</td><td></td><td></td></tr> <tr><td>20.0</td><td></td><td></td><td>0</td><td></td><td>2</td><td></td></tr> <tr><td>19.0</td><td></td><td>0</td><td></td><td>2</td><td>3</td><td></td></tr> <tr><td>18.5</td><td></td><td></td><td></td><td></td><td>3.5</td><td></td></tr> <tr><td>18.0</td><td>0</td><td></td><td>2</td><td>3</td><td></td><td></td></tr> <tr><td>17.5</td><td></td><td></td><td></td><td>3.5</td><td></td><td></td></tr> <tr><td>17.0</td><td></td><td>2</td><td>3</td><td></td><td></td><td></td></tr> <tr><td>16.5</td><td></td><td></td><td>3.5</td><td></td><td></td><td></td></tr> <tr><td>16.0</td><td>2</td><td>3</td><td></td><td></td><td></td><td></td></tr> <tr><td>15.5</td><td></td><td>3.5</td><td></td><td></td><td></td><td></td></tr> <tr><td>15.0</td><td>3</td><td></td><td></td><td></td><td></td><td></td></tr> <tr><td>14.5</td><td>3.5</td><td></td><td></td><td></td><td></td><td></td></tr> </tbody> </table>		Door overlay	Cup distance					Mounting plate height	3	4	5	6	7	22.0					0		21.0				0			20.0			0		2		19.0		0		2	3		18.5					3.5		18.0	0		2	3			17.5				3.5			17.0		2	3				16.5			3.5				16.0	2	3					15.5		3.5					15.0	3						14.5	3.5						<table border="1"> <thead> <tr> <th rowspan="2">Door overlay</th> <th colspan="5">Cup distance</th> <th rowspan="2">Mounting plate height</th> </tr> <tr> <th>3</th> <th>4</th> <th>5</th> <th>6</th> <th>7</th> </tr> </thead> <tbody> <tr><td>19.0</td><td></td><td></td><td></td><td></td><td>0</td><td></td></tr> <tr><td>18.0</td><td></td><td></td><td></td><td></td><td>0</td><td></td></tr> <tr><td>17.0</td><td></td><td></td><td>0</td><td></td><td>2</td><td></td></tr> <tr><td>16.5</td><td></td><td></td><td></td><td></td><td></td><td></td></tr> <tr><td>16.0</td><td></td><td>0</td><td></td><td>2</td><td>3</td><td></td></tr> <tr><td>15.5</td><td></td><td></td><td></td><td></td><td>3.5</td><td></td></tr> <tr><td>15.0</td><td>0</td><td></td><td>2</td><td>3</td><td></td><td></td></tr> <tr><td>14.5</td><td></td><td></td><td></td><td>3.5</td><td></td><td></td></tr> <tr><td>14.0</td><td></td><td>2</td><td>3</td><td></td><td></td><td></td></tr> <tr><td>13.5</td><td></td><td></td><td>3.5</td><td></td><td></td><td></td></tr> <tr><td>13.0</td><td>2</td><td>3</td><td></td><td></td><td></td><td></td></tr> <tr><td>12.5</td><td></td><td>3.5</td><td></td><td></td><td></td><td></td></tr> <tr><td>12.0</td><td>3</td><td></td><td></td><td></td><td></td><td></td></tr> <tr><td>11.5</td><td>3.5</td><td></td><td></td><td></td><td></td><td></td></tr> </tbody> </table>		Door overlay	Cup distance					Mounting plate height	3	4	5	6	7	19.0					0		18.0					0		17.0			0		2		16.5							16.0		0		2	3		15.5					3.5		15.0	0		2	3			14.5				3.5			14.0		2	3				13.5			3.5				13.0	2	3					12.5		3.5					12.0	3						11.5	3.5						<table border="1"> <thead> <tr> <th rowspan="2">Door overlay</th> <th colspan="5">Cup distance</th> <th rowspan="2">Mounting plate height</th> </tr> <tr> <th>3</th> <th>4</th> <th>5</th> <th>6</th> <th>7</th> </tr> </thead> <tbody> <tr><td>12.5</td><td></td><td></td><td></td><td></td><td>0</td><td></td></tr> <tr><td>11.5</td><td></td><td></td><td></td><td></td><td>0</td><td></td></tr> <tr><td>10.5</td><td></td><td></td><td>0</td><td></td><td>2</td><td></td></tr> <tr><td>10.0</td><td></td><td></td><td></td><td></td><td></td><td></td></tr> <tr><td>9.5</td><td></td><td>0</td><td></td><td>2</td><td>3</td><td></td></tr> <tr><td>9.0</td><td></td><td></td><td></td><td></td><td>3.5</td><td></td></tr> <tr><td>8.5</td><td>0</td><td></td><td>2</td><td>3</td><td></td><td></td></tr> <tr><td>8.0</td><td></td><td></td><td></td><td>3.5</td><td></td><td></td></tr> <tr><td>7.5</td><td></td><td>2</td><td>3</td><td></td><td></td><td></td></tr> <tr><td>7.0</td><td></td><td></td><td>3.5</td><td></td><td></td><td></td></tr> <tr><td>6.5</td><td>2</td><td>3</td><td></td><td></td><td></td><td></td></tr> <tr><td>6.0</td><td></td><td>3.5</td><td></td><td></td><td></td><td></td></tr> <tr><td>5.5</td><td>3</td><td></td><td></td><td></td><td></td><td></td></tr> <tr><td>5.0</td><td>3.5</td><td></td><td></td><td></td><td></td><td></td></tr> </tbody> </table>		Door overlay	Cup distance					Mounting plate height	3	4	5	6	7	12.5					0		11.5					0		10.5			0		2		10.0							9.5		0		2	3		9.0					3.5		8.5	0		2	3			8.0				3.5			7.5		2	3				7.0			3.5				6.5	2	3					6.0		3.5					5.5	3						5.0	3.5						<table border="1"> <thead> <tr> <th rowspan="2">Door reveal</th> <th colspan="5">Cup distance</th> <th rowspan="2">Mounting plate height</th> </tr> <tr> <th>3</th> <th>4</th> <th>5</th> <th>6</th> <th>7</th> </tr> </thead> <tbody> <tr><td>0.0</td><td></td><td>0</td><td></td><td>2</td><td>3</td><td></td></tr> <tr><td>0.5</td><td></td><td></td><td></td><td></td><td>3.5</td><td></td></tr> <tr><td>1.0</td><td>0</td><td></td><td>2</td><td>3</td><td></td><td></td></tr> <tr><td>1.5</td><td></td><td></td><td></td><td>3.5</td><td></td><td></td></tr> <tr><td>2.0</td><td></td><td>2</td><td>3</td><td></td><td></td><td></td></tr> <tr><td>3.0</td><td>2</td><td>3</td><td></td><td></td><td></td><td></td></tr> <tr><td>4.0</td><td>3</td><td></td><td></td><td></td><td></td><td></td></tr> </tbody> </table>	Door reveal	Cup distance					Mounting plate height	3	4	5	6	7	0.0		0		2	3		0.5					3.5		1.0	0		2	3			1.5				3.5			2.0		2	3				3.0	2	3					4.0	3					
Door overlay	Cup distance					Mounting plate height																																																																																																																																																																																																																																																																																																																																																																																																
	3	4	5	6	7																																																																																																																																																																																																																																																																																																																																																																																																	
22.0					0																																																																																																																																																																																																																																																																																																																																																																																																	
21.0				0																																																																																																																																																																																																																																																																																																																																																																																																		
20.0			0		2																																																																																																																																																																																																																																																																																																																																																																																																	
19.0		0		2	3																																																																																																																																																																																																																																																																																																																																																																																																	
18.5					3.5																																																																																																																																																																																																																																																																																																																																																																																																	
18.0	0		2	3																																																																																																																																																																																																																																																																																																																																																																																																		
17.5				3.5																																																																																																																																																																																																																																																																																																																																																																																																		
17.0		2	3																																																																																																																																																																																																																																																																																																																																																																																																			
16.5			3.5																																																																																																																																																																																																																																																																																																																																																																																																			
16.0	2	3																																																																																																																																																																																																																																																																																																																																																																																																				
15.5		3.5																																																																																																																																																																																																																																																																																																																																																																																																				
15.0	3																																																																																																																																																																																																																																																																																																																																																																																																					
14.5	3.5																																																																																																																																																																																																																																																																																																																																																																																																					
Door overlay	Cup distance					Mounting plate height																																																																																																																																																																																																																																																																																																																																																																																																
	3	4	5	6	7																																																																																																																																																																																																																																																																																																																																																																																																	
19.0					0																																																																																																																																																																																																																																																																																																																																																																																																	
18.0					0																																																																																																																																																																																																																																																																																																																																																																																																	
17.0			0		2																																																																																																																																																																																																																																																																																																																																																																																																	
16.5																																																																																																																																																																																																																																																																																																																																																																																																						
16.0		0		2	3																																																																																																																																																																																																																																																																																																																																																																																																	
15.5					3.5																																																																																																																																																																																																																																																																																																																																																																																																	
15.0	0		2	3																																																																																																																																																																																																																																																																																																																																																																																																		
14.5				3.5																																																																																																																																																																																																																																																																																																																																																																																																		
14.0		2	3																																																																																																																																																																																																																																																																																																																																																																																																			
13.5			3.5																																																																																																																																																																																																																																																																																																																																																																																																			
13.0	2	3																																																																																																																																																																																																																																																																																																																																																																																																				
12.5		3.5																																																																																																																																																																																																																																																																																																																																																																																																				
12.0	3																																																																																																																																																																																																																																																																																																																																																																																																					
11.5	3.5																																																																																																																																																																																																																																																																																																																																																																																																					
Door overlay	Cup distance					Mounting plate height																																																																																																																																																																																																																																																																																																																																																																																																
	3	4	5	6	7																																																																																																																																																																																																																																																																																																																																																																																																	
12.5					0																																																																																																																																																																																																																																																																																																																																																																																																	
11.5					0																																																																																																																																																																																																																																																																																																																																																																																																	
10.5			0		2																																																																																																																																																																																																																																																																																																																																																																																																	
10.0																																																																																																																																																																																																																																																																																																																																																																																																						
9.5		0		2	3																																																																																																																																																																																																																																																																																																																																																																																																	
9.0					3.5																																																																																																																																																																																																																																																																																																																																																																																																	
8.5	0		2	3																																																																																																																																																																																																																																																																																																																																																																																																		
8.0				3.5																																																																																																																																																																																																																																																																																																																																																																																																		
7.5		2	3																																																																																																																																																																																																																																																																																																																																																																																																			
7.0			3.5																																																																																																																																																																																																																																																																																																																																																																																																			
6.5	2	3																																																																																																																																																																																																																																																																																																																																																																																																				
6.0		3.5																																																																																																																																																																																																																																																																																																																																																																																																				
5.5	3																																																																																																																																																																																																																																																																																																																																																																																																					
5.0	3.5																																																																																																																																																																																																																																																																																																																																																																																																					
Door reveal	Cup distance					Mounting plate height																																																																																																																																																																																																																																																																																																																																																																																																
	3	4	5	6	7																																																																																																																																																																																																																																																																																																																																																																																																	
0.0		0		2	3																																																																																																																																																																																																																																																																																																																																																																																																	
0.5					3.5																																																																																																																																																																																																																																																																																																																																																																																																	
1.0	0		2	3																																																																																																																																																																																																																																																																																																																																																																																																		
1.5				3.5																																																																																																																																																																																																																																																																																																																																																																																																		
2.0		2	3																																																																																																																																																																																																																																																																																																																																																																																																			
3.0	2	3																																																																																																																																																																																																																																																																																																																																																																																																				
4.0	3																																																																																																																																																																																																																																																																																																																																																																																																					

MINIMUM GAP

Door thickness	Cup distance					Minimum gap
	3	4	5	6	7	
24.0	1.0	1.0	1.0	1.2 ²	2.1 ²	
22.0	1.0	1.0	1.0	1.0	1.5 ²	
21.0	1.0	1.0	1.0	1.0	1.2 ²	
20.0	1.0	1.0	1.0	1.0	1.0	
19.0	1.0	1.0	1.0	1.0	1.0	
18.0	1.0	1.0	1.0	1.0	1.0	
17.0	1.0	1.0	1.0	1.0	1.0	
16.0	1.0	1.0	1.0	1.0	1.0	

² 1.0 at 85° opening angle

MINIMUM REVEAL

Door thickness	Cup distance					Minimum reveal (F)
	3	4	5	6	7	
24.0	2.4	2.1	2.1	2.1	2.0	
22.0	1.6	1.6	1.6	1.5	1.5	
21.0	1.4	1.3	1.3	1.3	1.3	
20.0	1.1	1.1	1.1	1.1	1.1	
19.0	0.9	0.9	0.9	0.9	0.9	
18.0	0.7	0.7	0.7	0.7	0.7	
17.0	0.6	0.6	0.6	0.6	0.6	
16.0	0.6	0.6	0.6	0.6	0.6	

85° OPENING ANGLE

Door thickness	Cup distance					Minimum reveal (F) ² at 85°
	3	4	5	6	7	
36.0	11.1	10.3	9.7	9.1	8.5	
30.0	5.4	4.8	4.4	4.3	4.2	
28.0	3.7	3.6	3.5	3.4	3.3	
26.0	2.9	2.8	2.8	2.7	2.6	
24.0	2.2	2.1	2.1	2.1	2.0	
22.0	1.6	1.6	1.6	1.5	1.5	
21.0	1.4	1.3	1.3	1.3	1.3	
20.0	1.1	1.1	1.1	1.1	1.1	
19.0	0.9	0.9	0.9	0.9	0.9	
18.0	0.7	0.7	0.7	0.7	0.7	
16.0	0.6	0.6	0.6	0.6	0.6	

² 85° opening angle reduction clip

NOTES

The minimum gap is the clearance required between the front edge of the cabinet and the closed door so that the door can open without hindrance.

Minimum reveal for doors with bevelled edges (R = 1 mm) (factory setting).

For door thicknesses of 24 mm and above, a trial fitting is recommended.

DRILLING PATTERNS 45/9.5

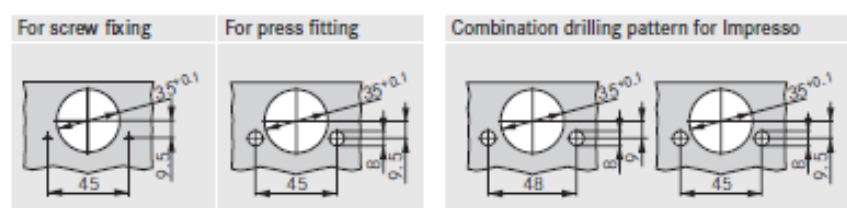

CUP DIMENSIONS

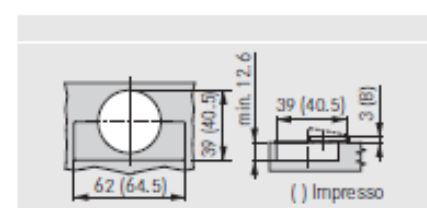

TIOMOS 120

120° hinge (door thicknesses up to 24 mm)



- 120° opening angle
- Optimum reveals for door thicknesses up to 22 mm
- Convenient depth adjustment via worm gear
- 3-dimensional adjustment with appropriate mounting plate

Available in 3 versions:

- With integrated damper (3 adjustable damping levels)
- Without integrated damper
- Without self-closing mechanism (without spring)

ORDER INFORMATION FOR DRILLING PATTERN 45/9.5

Door overlay	Cranking	Damper			Item No.		
		with	without	without spring	Click-on For screw fixing	Click-on For press fitting	Impresso without tools
Full overlay ¹	0	■	-	-	F028138547	F028138551	F017139343
		-	■	-	F045138485	F045138489	F034139314
		-	■	■	F046138607	-	F035139371
Overlay ¹	3	■	-	-	F028138548	F028138552	F017139344
		-	■	-	F045138486	F045138490	F034139315
		-	■	■	F046138608	-	F035139372
Half overlay ²	9.5	■	-	-	F028138549	F028138553	F017139345
		-	■	-	F045138487	F045138491	F034139316
		-	■	■	F046138609	-	F035139373
Inset ²	19	■	-	-	F028138550	F028138554	F017139346
		-	■	-	F045138488	F045138492	F034139317
		-	■	■	F046138610	-	F035139374

¹ Cup material: steel, nickel-plated / Arm material: steel, nickel-plated

² Cup material: steel, nickel-plated / Arm material: Zamak, nickel-plated

COVER CAPS

	Designation	Cranking	Imprinted/Embossed	Item No.
	Hinge arm cover cap, steel, nickel-plated, not imprinted	0/3/9.5/19	On request	F072135500
	Hinge arm cover cap, steel, long, nickel-plated, not imprinted	0/3	On request	F072135504
	Hinge cup cover cap, steel, nickel-plated, not imprinted	0/3/9.5/19	-	F072135503

ACCESSORIES

	Designation	Item No.		Designation	Item No.
	85° opening angle reduction clip	F072135751		Countersunk wood screw Ø 3.5 x 15 mm	F146073976
	Tipmatic Pin for wooden and aluminium frame doors	F069068873			

TIOMOS 160

160° wide-angle hinge (door thicknesses up to 32 mm)

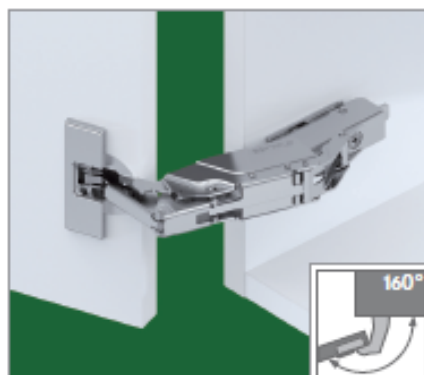

- 160° opening angle
- Convenient depth adjustment via worm gear
- For cabinets with inset drawers or pull-out shelves
- Optimum reveals for door thicknesses up to 32 mm
- 3-dimensional adjustment with appropriate mounting plate
- Minimum reveals
- Shallow cup depth

Available in 3 versions:

- With integrated damper (3 adjustable damping levels)
- Without integrated damper
- Without self-closing mechanism (without spring)

ORDER INFORMATION FOR DRILLING PATTERN 45/9.5

Door overlay	Cranking	Damper			Item No.		
		with	without	without spring	Click-on For screw fixing	Click-on For press fitting	Impresso without tools
Full overlay ¹	0	■	-	-	F028138561	F028138564	F017139350
		-	■	-	F045138499	F045138502	F034139321
		-	■	■	F046138621	-	F035139378
Overlay ¹	3	■	-	-	F028138562	F028138565	F017139351
		-	■	-	F045138500	F045138503	F034139322
		-	■	■	F046138622	-	F035139379
Half overlay ¹	9.5	■	-	-	F028138563	F028138566	F017139352
		-	■	-	F045138501	F045138504	F034139323
		-	■	■	F046138623	-	F035139380

¹ Cup material: Zamak, nickel-plated / Arm material: Zamak, nickel-plated

ACCESSORIES

	Designation	Item No.
	120° opening angle reduction clip	F072135753
	Tipmatic Pin for wooden and aluminium frame doors	F069068873

	Designation	Item No.
	Countersunk wood screw Ø 3.5 x 15 mm	F146073976

MITRED APPLICATION (ON ALL SIDES)

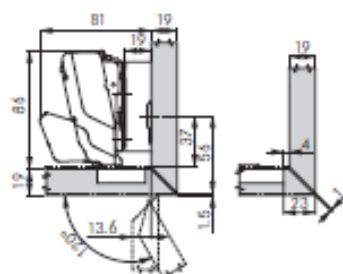

With 0 cranking, mounting plate height 19 mm and cup distance 4 mm, door and cabinet edges can meet at mitred angles on all 4 sides.

Use 120° opening angle reduction clip.

ZERO PROTRUSION

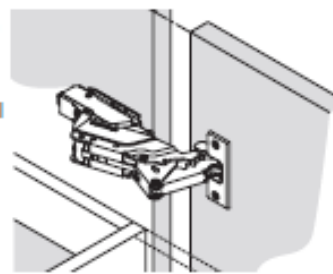

For cabinets with inset drawers.

At 0 cranking, and with all mounting plate thicknesses, the door protrudes inwards at 90°. With cranking size 3 and mounting plate height 3 mm, the door will be flush with the cabinet.

TIOMOS PCC

pie-cut corner hinge

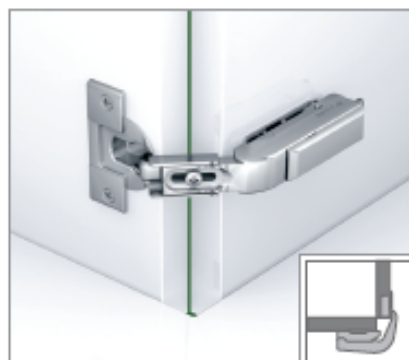

- For connecting two corner cabinet doors
- For door thicknesses up to max. 24 mm (factory setting for 19 mm door thickness for a cup distance of 3.5 mm)
- 35mm full cup drill hole
- Shallow cup depth of 11.8mm
- 3-dimensional adjustment with appropriate mounting plate
- Without integrated damper

Available in 1 version:

- Without integrated damper

ORDER INFORMATION FOR DRILLING PATTERN 45/9.5

Door overlay		Damper			Item No.		
		with	without	without spring	Click-on For screw fixing	Click-on For press fitting	
		-	■	-	F045138517	F045138518	

¹ Cup material: steel, nickel-plated / Arm material: Zamak, nickel-plated

² Available on request

COVER CAPS

	Designation	Cranking	Imprinted/Embossed	Item No.
	Hinge arm cover cap, steel, nickel-plated, not imprinted	0/3/9.5/19	On request	F072135500
	Hinge arm cover cap, steel, long, nickel-plated, not imprinted	0/3	On request	F072135504
	Hinge cup cover cap, steel, nickel-plated, not imprinted	0/3/9.5/19	-	F072135503

ACCESSORIES

	Designation	Item No.		Designation	Item No.
	Countersunk wood screw Ø 3.5 x 15 mm	F146073976			

INSTALLATION INFORMATION

All dimensions in millimetres

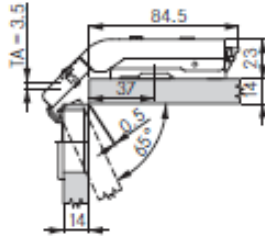

Door thickness (TS) 14 mm
Cup distance (TA) 3.5 mm
Mounting plate height 0

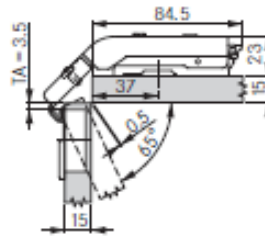

Door thickness (TS) 15 mm
Cup distance (TA) 3.5 mm
Mounting plate height 0

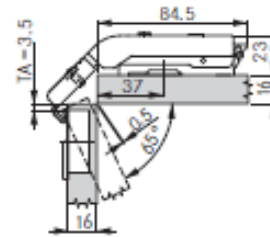

Door thickness (TS) 16 mm
Cup distance (TA) 3.5 mm
Mounting plate height 0

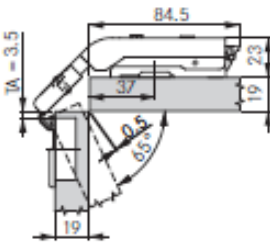

Door thickness (TS) 19 mm (factory setting)
Cup distance (TA) 3.5 mm
Mounting plate height 0

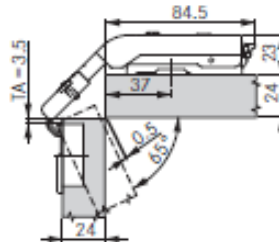

Door thickness (TS) 24 mm
Cup distance (TA) 3.5 mm
Mounting plate height 0

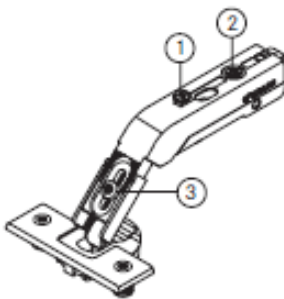

Adjustment in the hinge arm:

1. Stepless side adjustment ± 2 mm
2. Stepless depth adjustment via worm gear $+3/-2$ mm
3. Door thickness 14 - 24 mm (factory setting 19 mm)

Height adjustment via mounting plate

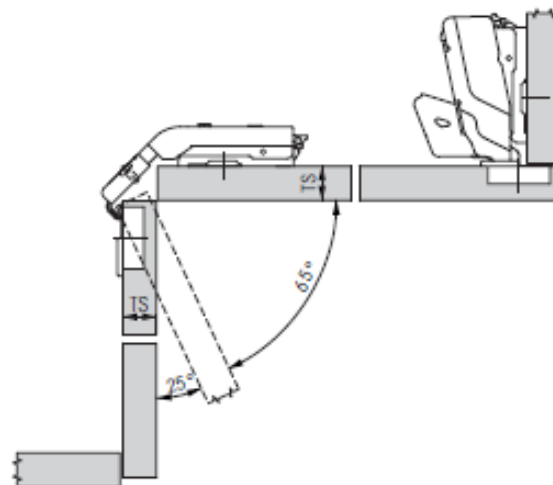

DRILLING PATTERNS 45/9.5

For screw fixing

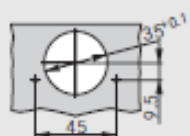

For press fitting

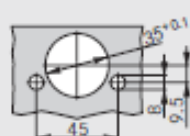

Combination drilling pattern for Impresso

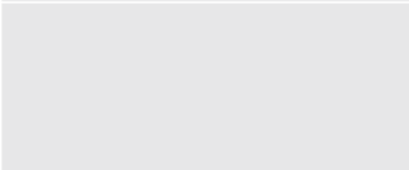

CUP DIMENSIONS

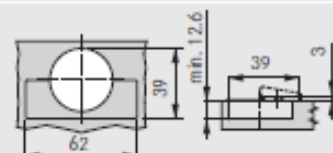

TIOMOS 110/90E

110° blind corner hinge (inset)



- Hinge for blind corner constructions
- 110° opening angle
- Convenient depth adjustment via worm gear
- 3-dimensional adjustment with appropriate mounting plate
- Minimum reveals

Available in 3 versions:

- With integrated damper (3 adjustable damping levels)
- Without integrated damper
- Without self-closing mechanism (without spring)

ORDER INFORMATION FOR DRILLING PATTERN 45/9.5

Door overlay		Damper			Item No.		
		with	without	without spring	Click-on For screw fixing	Click-on For press fitting	Impresso without tools
Inset ¹		■	-	-	F028138536	F028138546	F017139342
		-	■	-	F045138474	F045138484	F034139313
		-	■	■	F046138596	-	-

¹ Cup material: steel, nickel-plated / Arm material: Zamak, nickel-plated

COVER CAPS

	Designation	Cranking	Imprinted/ Embossed	Item No.
	Hinge arm cover cap, steel, nickel-plated, not imprinted	0/3/9.5/19	On request	F072135500
	Hinge arm cover cap, steel, long, nickel-plated, not imprinted	0/3	On request	F072135504
	Hinge cup cover cap, steel, nickel-plated, not imprinted	0/3/9.5/19	-	F072135503

ACCESSORIES

	Designation	Item No.		Designation	Item No.
	Tipmatic Pin for wooden and aluminium frame doors	F069068873			
	Countersunk wood screw Ø 3.5 x 15 mm	F146073976			

INSTALLATION INFORMATION

All dimensions in millimetres

Inset

Cross mounting plates with fixing distance 37

Drilling distance (X)	Cup distance				
	4	5	6	7	
28.0	1	0			
27.0	2	1	0		
26.0	3	2	1	0	
	Door reveal				

Linear mounting plates

Drilling distance (X)	Cup distance				
	4	5	6	7	
11.0	1	0			
10.0	2	1	0		
9.0	3	2	1	0	
	Door reveal				

Mounting plate height 3

MINIMUM REVEAL

Door thickness	Cup distance					
	3	4	5	6	7	
24.0	2.4	2.1	2.1	2.1	2.1	2.0
22.0	1.6	1.6	1.6	1.5	1.5	
21.0	1.4	1.3	1.3	1.3	1.3	
20.0	1.1	1.1	1.1	1.1	1.1	
19.0	0.9	0.9	0.9	0.9	0.9	
18.0	0.7	0.7	0.7	0.7	0.7	
17.0	0.6	0.6	0.6	0.6	0.6	
16.0	0.6	0.6	0.6	0.6	0.6	
	Minimum reveal (F)					

NOTES

Minimum reveal for doors with bevelled edges (R = 1 mm) (factory setting).

Use standard mounting plate height 3 to ensure that door is flush fitting.

TIOMOS 110/30A

+30° angle corner cabinet hinge (overlay)



- For 30° angled cabinets
- 110° opening angle
- Convenient depth adjustment via worm gear
- 3-dimensional adjustment with appropriate mounting plate
- Minimum reveals

Available in 3 versions:



- With integrated damper (3 adjustable damping levels)
- Without integrated damper
- Without self-closing mechanism (without spring)

ORDER INFORMATION FOR DRILLING PATTERN 45/9.5



Door overlay		Damper			Item No.		
		with	without	without spring	Click-on For screw fixing		Impresso without tools
Overlay ¹		■	-	-	F028138529		F017139335
		-	■	-	F045138467		F034139306
		-	■	■	F046138589		-

¹ Cup material: steel, nickel-plated / Arm material: Zamak, nickel-plated

COVER CAPS

	Designation	Imprinted/ Embossed	Item No.
	Hinge arm cover cap, steel, nickel-plated, not imprinted	On request	F072135500
	Hinge cup cover cap, steel, nickel-plated, not imprinted	-	F072135503

ACCESSORIES

	Designation	Item No.		Designation	Item No.
	Tipmatic Pin for wooden and aluminium frame doors	F069068873			
	Countersunk wood screw Ø 3.5 x 15 mm	F146073976			

INSTALLATION INFORMATION

All dimensions in millimetres

overlay

Mounting plate height 0 Mounting plate height 6 Mounting plate height 9

Cup distance		3	4	5	6	7
20.5						0
19.5					0	
18.5				0		2
17.5		0			2	3
16.5	0					3.5
16.0				2	3	
15.5					3.5	
15.0		2	3			
14.5				3.5		
14.0	2	3				
13.5		3.5				
13.0	3					
12.5	3.5				6	
11.5				6		
10.5		6				

Door overlay

Mounting plate height

Cross mounting plates with fixing distance 37 Linear mounting plates

Mounting plate height		0	2	3	3.5	6
X		34.0	33.0	32.0	32.0	30.5

Cross mounting plate position (X)

Mounting plate height		0	2	3	3.5
X		17.0	16.0	15.0	15.0

Linear mounting plate position (X)

MINIMUM GAP

Cup distance		3	4	5	6	7
24.0	1.0	1.0	1.0	1.2	2.1	
22.0	1.0	1.0	1.0	1.0	1.5	
21.0	1.0	1.0	1.0	1.0	1.2	
20.0	1.0	1.0	1.0	1.0	1.0	
19.0	1.0	1.0	1.0	1.0	1.0	
18.0	1.0	1.0	1.0	1.0	1.0	
17.0	1.0	1.0	1.0	1.0	1.0	
16.0	1.0	1.0	1.0	1.0	1.0	

Door overlay

Minimum gap

MINIMUM REVEAL

Cup distance		3	4	5	6	7
24.0	2.4	2.1	2.1	2.1	2.0	
22.0	1.6	1.6	1.6	1.5	1.5	
21.0	1.4	1.3	1.3	1.3	1.3	
20.0	1.1	1.1	1.1	1.1	1.1	
19.0	0.9	0.9	0.9	0.9	0.9	
18.0	0.7	0.7	0.7	0.7	0.7	
17.0	0.6	0.6	0.6	0.6	0.6	
16.0	0.6	0.6	0.6	0.6	0.6	

Door thickness

Minimum reveal (F)

NOTES

The minimum gap is the clearance required between the front edge of the cabinet and the closed door so that the door can open without hindrance.

Minimum reveal for doors with bevelled edges (R = 1 mm) (factory setting).

Hinge dimensions and reveal calculation with factory setting.

For door thicknesses of 24 mm and above, a trial fitting is recommended.

DRILLING PATTERNS 45/9.5

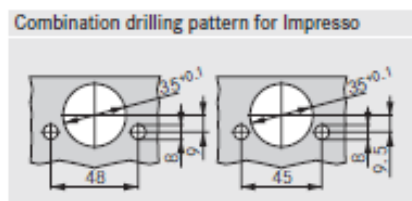
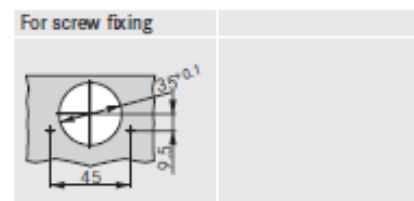

CUP DIMENSIONS

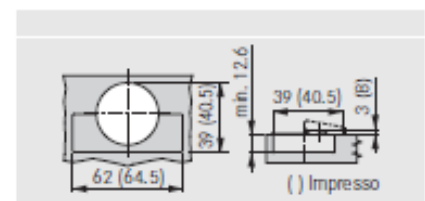

TIOMOS / 1 10/45A

+45° angle corner cabinet hinge (overlay)



- For 45° angled cabinets
- 110° opening angle
- Convenient depth adjustment via worm gear
- 3-dimensional adjustment with appropriate mounting plate
- Minimum reveals

Available in 3 versions:

- With integrated damper (3 adjustable damping levels)
- Without integrated damper
- Without self-closing mechanism (without spring)

ORDER INFORMATION FOR DRILLING PATTERN 45/9.5

Door overlay		Damper			Item No.		
		with	without	without spring	Click-on For screw fixing		Impresso without tools
Overlay †		■	-	-	F028138533		F017139339
		-	■	-	F045138471		F034139310
		-	■	■	F046138593		-

† Cup material: steel, nickel-plated / Arm material: Zamak, nickel-plated

COVER CAPS

	Designation	Imprinted/ Embossed	Item No.
	Hinge arm cover cap, steel, nickel-plated, not imprinted	On request	F072135500
	Hinge cup cover cap, steel, nickel-plated, not imprinted	-	F072135503

ACCESSORIES

	Designation	Item No.		Designation	Item No.
	Tipmatic Pin for wooden and aluminium frame doors	F069068873			
	Countersunk wood screw Ø 3.5 x 15 mm	F146073976			

INSTALLATION INFORMATION

All dimensions in millimetres

overlay

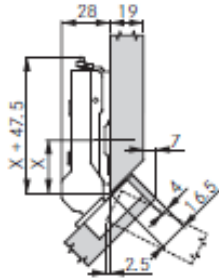

Mounting plate height 0

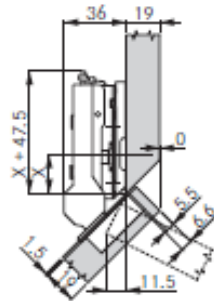

Mounting plate height 8

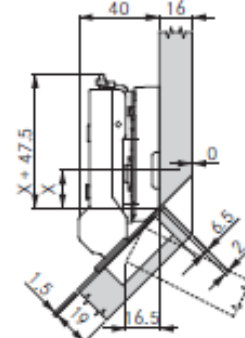

Mounting plate height 12

Door overlay	Cup distance				
	3	4	5	6	7
19.5					0
19.0					
18.5				0	
18.0					
17.5			0		
17.0					
16.5		0			2
16.0					
15.5	0			2	
15.0					3
14.5			2	3.5	
14.0				3	
13.5		2		3.5	
13.0			3		
12.5	2		3.5		
12.0		3			
11.0	3				6
10.0				6	

Mounting plate height

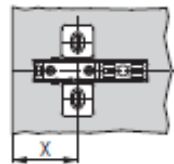

Cross mounting plates with fixing distance 37

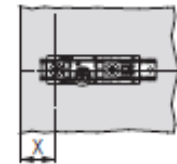

Linear mounting plates

X	Mounting plate height				
	0	2	3	3.5	6
X	30.5	28.5	27.5	27.0	24.5

Cross mounting plate position (X)

X	Mounting plate height				
	0	2	3	3.5	
X	13.5	11.5	10.5	10.0	

Linear mounting plate position (X)

MINIMUM GAP

Door overlay	Cup distance				
	3	4	5	6	7
24.0	1.0	1.0	1.0	1.2	2.1
22.0	1.0	1.0	1.0	1.0	1.5
21.0	1.0	1.0	1.0	1.0	1.2
20.0	1.0	1.0	1.0	1.0	1.0
19.0	1.0	1.0	1.0	1.0	1.0
18.0	1.0	1.0	1.0	1.0	1.0
17.0	1.0	1.0	1.0	1.0	1.0
16.0	1.0	1.0	1.0	1.0	1.0

Minimum gap

MINIMUM REVEAL

Door thickness	Cup distance				
	3	4	5	6	7
24.0	2.4	2.1	2.1	2.1	2.0
22.0	1.6	1.6	1.6	1.5	1.5
21.0	1.4	1.3	1.3	1.3	1.3
20.0	1.1	1.1	1.1	1.1	1.1
19.0	0.9	0.9	0.9	0.9	0.9
18.0	0.7	0.7	0.7	0.7	0.7
17.0	0.6	0.6	0.6	0.6	0.6
16.0	0.6	0.6	0.6	0.6	0.6

Minimum reveal (F)

NOTES

The minimum gap is the clearance required between the front edge of the cabinet and the closed door so that the door can open without hindrance.

Minimum reveal for doors with bevelled edges (R = 1 mm) (factory setting).

For door thicknesses of 24 mm and above, a trial fitting is recommended.

DRILLING PATTERNS 45/9.5

For screw fixing

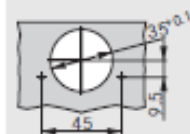

Combination drilling pattern for Impresso

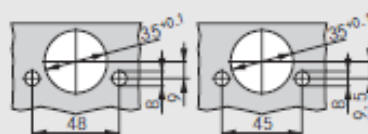

CUP DIMENSIONS

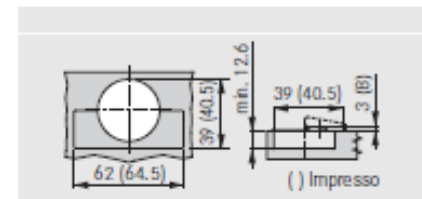

TIOMOS

Mounting plates

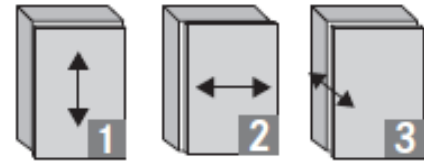
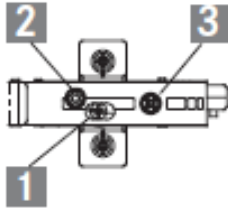

(HV) Height adjustment
+/- 2 mm

(SV) Side adjustment
+/- 2 mm

(TV) Depth adjustment
+3/-2 mm

All adjustments can be carried out independently of each other.

ORDER INFORMATION

1D CROSS MOUNTING PLATE, 4-POINT FIXING

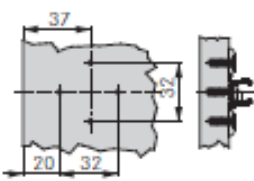
For screw fixing	37/32	Height	Item No.
<ul style="list-style-type: none"> Steel, nickel-plated Fixing with wood screws $\varnothing 3.5 \times 15$ mm With convenient height adjustment (HV) via worm gear 		0	F058 139746
		2	F058 139747
		3	F058 139748
		3.5	F058 139749

1D CROSS MOUNTING PLATE, 4-POINT FIXING

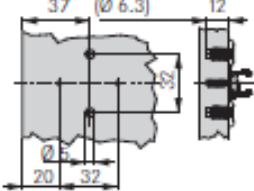
For Euro screws	37/32	Height	Item No.
<ul style="list-style-type: none"> Steel, nickel-plated Fixing with Euro screws $\varnothing 6.3$ mm With convenient height adjustment (HV) via worm gear 		0	F058 139756
		2	F058 139757
		3	F058 139758
		3.5	F058 139759

1D CROSS MOUNTING PLATE, 4-POINT FIXING

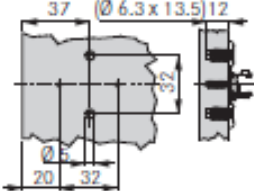
With pre-assembled Euro screws (13.5 mm)	37/32	Height	Item No.
<ul style="list-style-type: none"> Steel, nickel-plated Fixing with pre-assembled Euro screws With convenient height adjustment (HV) via worm gear 		0	F058 139761
		2	F058 139762
		3	F058 139763
		3.5	F058 139764

11D CROSS MOUNTING PLATE, 4-POINT FIXING, FOR TWIN APPLICATION

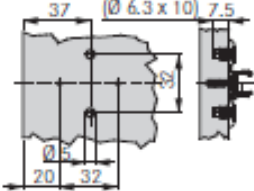
With pre-assembled Euro screws (10 mm)	37/32	Height	Item No.
<ul style="list-style-type: none"> Steel, nickel-plated Fixing with pre-assembled Euro screws With convenient height adjustment (HV) via worm gear For twin application 		0	F058 139863
		2	F058 139864
		3	F058 139865
		3.5	F058 139866

TIOMOS

Mounting plates

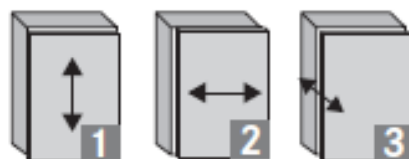
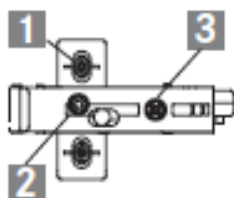

(HV) Height adjustment
+/- 2.5 mm



(SV) Side adjustment
+/- 2 mm

(TV) Depth adjustment
+3/-2 mm

All adjustments can be carried out independently of each other.

ORDER INFORMATION

ECO CROSS MOUNTING PLATE, 3-POINT FIXING

For screw fixing	37 / 32	Height	Item No.
<ul style="list-style-type: none"> Steel, nickel-plated Fixing with wood screws $\varnothing 3.5 \times 15$ mm Height adjustment (HV) via slot 		-2	F058139720
		0	F058139721
		2	F058139722
		3	F058139723
		3.5	F058139724

ECO CROSS MOUNTING PLATE, 3-POINT FIXING

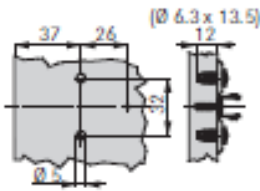
With pre-assembled pan head Euro screws (13.5 mm)	37 / 32	Height	Item No.
<ul style="list-style-type: none"> Steel, nickel-plated Fixing with pre-assembled pan head Euro screws Height adjustment (HV) via slot 		-2	F058139735
		0	F058139736
		2	F058139737
		3	F058139738
		3.5	F058139739

ECO CROSS MOUNTING PLATE, 3-POINT FIXING, FOR TWIN APPLICATION

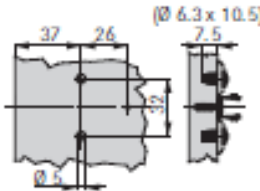
With pre-assembled pan head Euro screws (10.5 mm)	37 / 32	Height	Item No.
<ul style="list-style-type: none"> Steel, nickel-plated Fixing with pre-assembled pan head Euro screws Height adjustment (HV) via slot For twin application 		-2	F058139857
		0	F058139858
		2	F058139859
		3	F058139860
		3.5	F058139861

ECO CROSS MOUNTING PLATE, 3-POINT FIXING

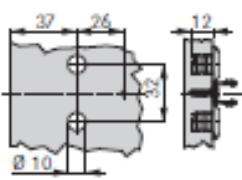
For press fitting	37 / 32	Height	Item No.
<ul style="list-style-type: none"> Steel, nickel-plated Fixing with $\varnothing 10$ mm dowels Height adjustment (HV) via slot Do not use a hammer for inserting the mounting plate 		-2	F058139725
		0	F058139726
		2	F058139727
		3	F058139728
		3.5	F058139729

TIOMOS

Mounting plates

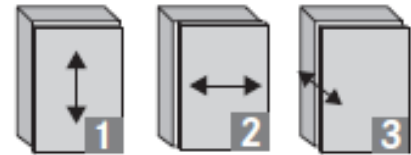
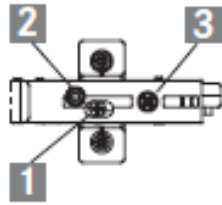

(HV) Height adjustment
+/- 2 mm

(SV) Side adjustment
+/- 2 mm

(TV) Depth adjustment
+3/-2 mm

All adjustments can be carried out independently of each other.

ORDER INFORMATION

1D CROSS MOUNTING PLATE, 2-POINT SCREW FIXING

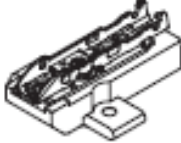
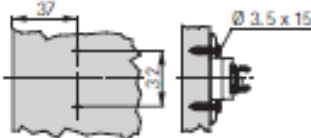
For screw fixing	37 / 32	Height	Item No.
<ul style="list-style-type: none"> Zamak/steel, nickel-plated Fixing with wood screws (3.5 x 15 mm) With convenient height adjustment (HV) via worm gear 		6	F058130892
		8	F058130886
		9	F058130887
		9.5	F058130888
		12	F058130893
		14	F058130889
		15	F058130890
		15.5	F058130891
		19	F058130894
		21	F058130895



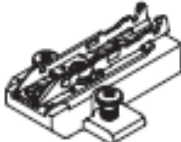
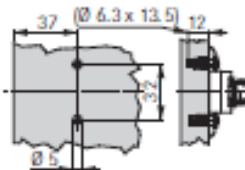

1D CROSS MOUNTING PLATE, 2-POINT FIXING

With pre-assembled Euro screws (13.5 mm)	37 / 32	Height	Item No.
<ul style="list-style-type: none"> Zamak/steel, nickel-plated Fixing with pre-assembled Euro screws With convenient height adjustment (HV) via worm gear 		6	F058130873
		8	F058130880
		9	F058130881
		9.5	F058130882
		12	F058130874
		14	F058130883
		15	F058130884
		15.5	F058130885
		19	F058130875
		21	F058130896



TIOMOS

Accessories









COVER CAPS

	Designation	Cranking	Imprinted/ Embossed	Item No.
	Hinge arm cover cap, steel, nickel-plated, not imprinted	0/3/9.5/19	On request	F07 2135500
	Hinge arm cover cap, steel, long, nickel-plated, not imprinted	0/3	On request	F07 2135504
	Hinge arm cover cap, left, steel, nickel-plated, GRASS imprint	0/3/9.5/19	GRASS logo	F07 2135550
	Hinge arm cover cap, right, steel, nickel-plated, GRASS logo			F07 2135551
	Hinge cup cover cap, steel, nickel-plated, not imprinted	-	On request	F07 2135503

OPENING ANGLE REDUCTION CLIPS

	Designation			Item No.
	85° opening angle reduction clip Suitable for all Tiomos 110° and 120° standard hinges. Prevents the door from colliding with kitchen unit fronts or walls (when fitted at corners). Easy fitting without tools. Steel, without nickel-plating			F07 2135751
	120° opening angle reduction clip Suitable for all Tiomos 160° wide-angle hinges. Prevents the door from colliding with kitchen unit fronts or walls (when fitted at corners). Easy fitting without tools. Plastic, black			F07 2135753

FIXING SCREWS, DOWELS

	Designation			Item No.
	Flat head Euro screw, nickel-plated, Ø 6.3 x 10.5 mm			F07 2135768
	Flat head Euro screw, nickel-plated, Ø 6.3 x 13.5 mm			F07 2135309
	Countersunk Euro screw, nickel-plated, Ø 6.3 x 10 mm			F07 2135779
	Countersunk Euro screw, nickel-plated, Ø 6.3 x 13.5 mm			F069135297
	Chipboard screw, nickel-plated, Ø 3.5 x 15 mm			F146073976
	Steel housing fixing screw for aluminium frame hinge, nickel-plated, M 3 x 6 mm			F069073405
	Dowel for hinge cup, plastic PA 6.6, Ø 8 x 13.2 mm (not compatible with 160° wide-angle hinge)			F07 2135773
	Dowel for hinge cup, plastic PA 6.6, Ø 10 x 13.2 mm (not compatible with 160° wide-angle hinge)			F07 2135798

ASSEMBLY INSTRUCTIONS

All dimensions in millimetres

85° opening angle reduction clip

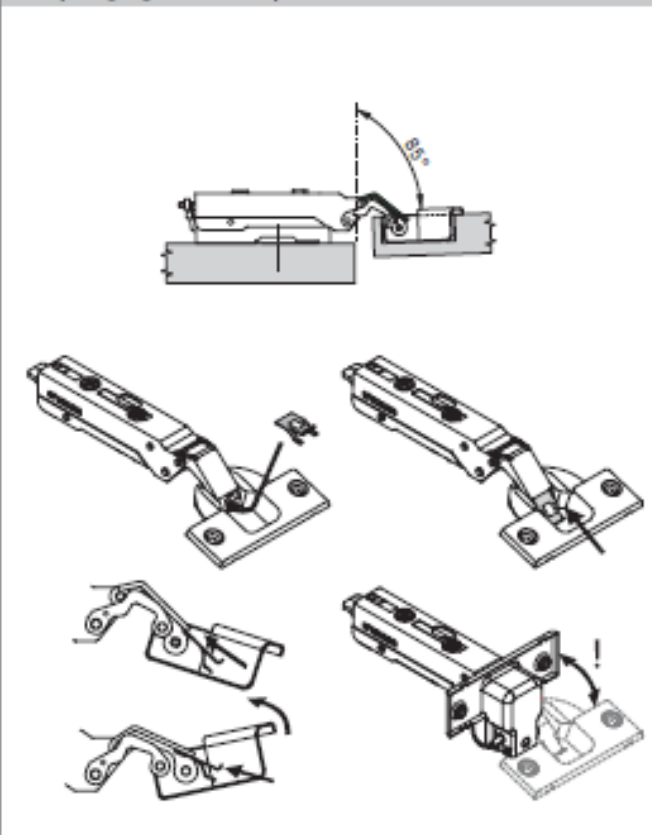

120° opening angle reduction clip

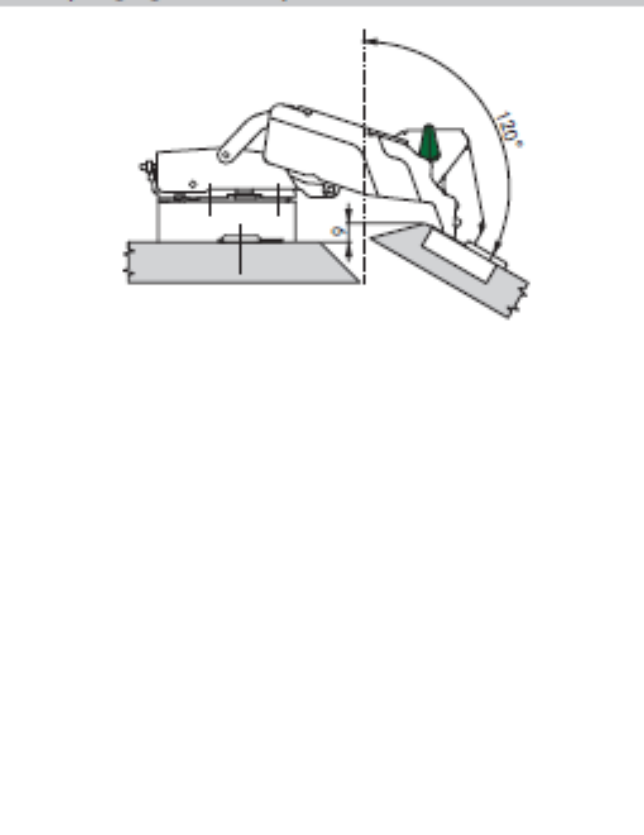

TIOMOS

Technical information

NUMBER OF HINGES PER DOOR

Description

The number of hinges is determined by the door height, door weight, quality of the material and the fixing of the cup and mounting plate.

The load and height data refer to 600 mm standard door widths. In case of doubt, the number of hinges should be determined with a trial fitting.

Example:

For doors measuring 2000 x 600 mm and weighing 13 kg we recommend the installation of 4 hinges.



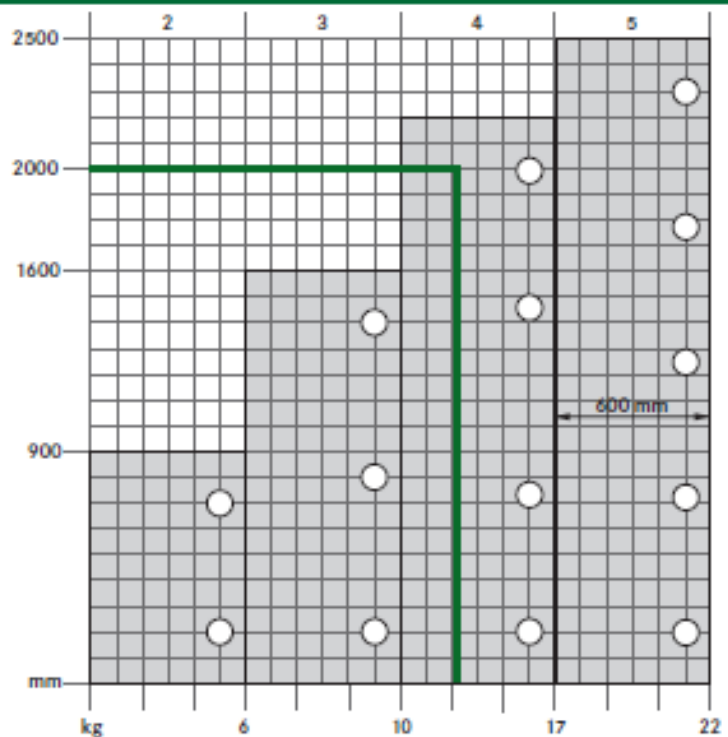

The table refers to hinges with and without integrated damper.

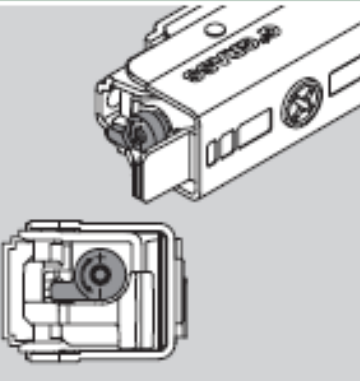
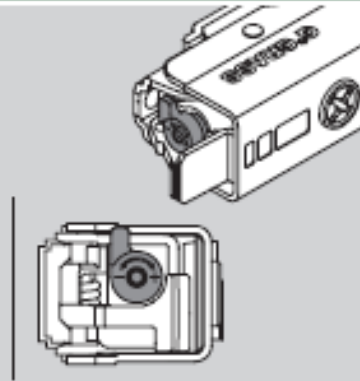
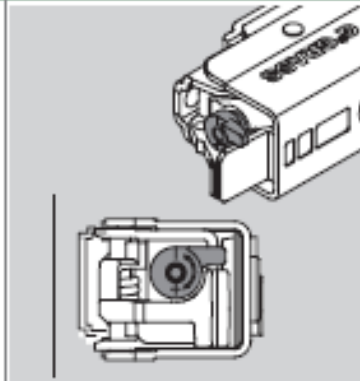

TOOL-FREE DAMPER ADJUSTMENT

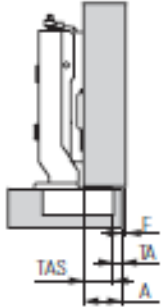
Low level	Medium level (factory setting)	High level
		
<p>Adjustment lever points</p> <ul style="list-style-type: none"> towards cabinet wall <p>Suitable for:</p> <ul style="list-style-type: none"> small, light-weight doors 	<p>Adjustment lever points</p> <ul style="list-style-type: none"> downwards when fitted on the left and upwards when fitted on the right <p>Suitable for:</p> <ul style="list-style-type: none"> standard doors 	<p>Adjustment lever points</p> <ul style="list-style-type: none"> into the cabinet <p>Suitable for:</p> <ul style="list-style-type: none"> large, heavy doors
<p>The damping force of each hinge can be set individually. A simple lever adjustment is all that is required to increase or reduce the damping force as required.</p>		

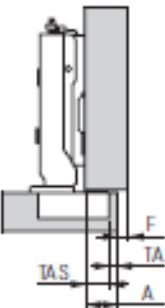
OPTIONS FOR CHANGING THE DOOR OVERLAY

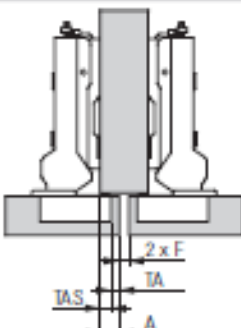
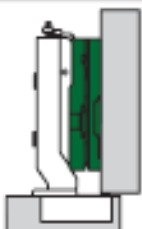
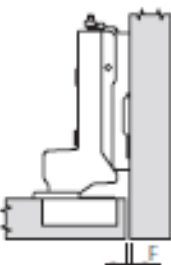
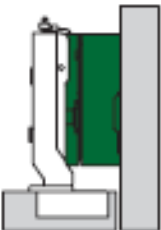
By selecting the cranking	By using a mounting plate with a different height
<p>Full overlay (cranking 0)</p> <p>The cup overlay (TAS/ factory setting) plus cup distance (TA) is the door overlay (A).</p> <p>The dimensions are shown in a table on the respective catalogue page.</p> 	<p>Full overlay</p> <p>Use a hinge with cranking 0 and mounting plate height 0.</p> 
<p>Overlay (cranking 3)</p> <p>The cup overlay (TAS/ factory setting) plus cup distance (TA) is the door overlay (A).</p> <p>The dimensions are shown in a table on the respective catalogue page.</p> 	<p>overlay</p> <p>Use a hinge with cranking 0 and mounting plate height 3.</p> 
<p>Half overlay (cranking 9.5)</p> <p>The cup overlay (TAS/ factory setting) plus cup distance (TA) is the door overlay (A).</p> <p>The dimensions are shown in a table on the respective catalogue page.</p> 	<p>Half overlay</p> <p>Use of a hinge with cranking 0 and mounting plate height 9.5.</p> 
<p>Inset (cranking 19)</p> <p>There is no door overlay. The minimum reveal (F) between the cabinet side and door depends on the mounting plate height and the cup distance. The dimensions are shown in a table on the respective catalogue page.</p> 	<p>Inset</p> <p>Use a hinge with cranking 0 and mounting plate height 21.</p> 

TIOMOS

Technical information

TEST CRITERIA FOR HINGES

Functional test

Static load – vertical

Additional load: 20 kg
Opening angle: max. -10°
Number: 10

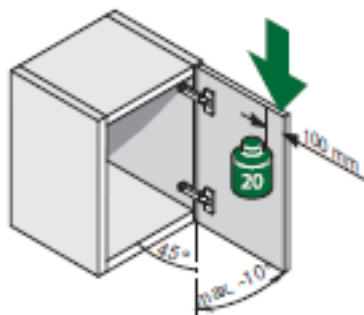

Static load – horizontal

Force: 40 N
Number: 10

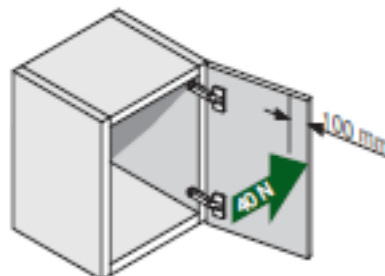

Endurance test

Opening angle: max. -5°
Open and close movements: 100,000

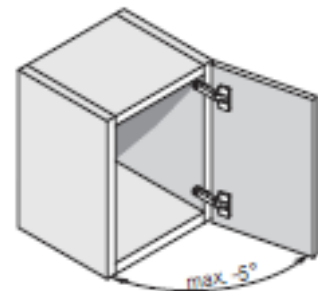

Overload testing

Vertical

Additional load: 30 kg
Opening angle: max. -10°
Number: 10

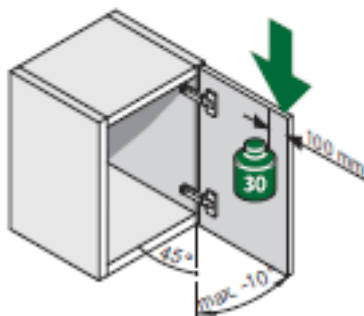

Horizontal

Force: 80 N
Number: 10

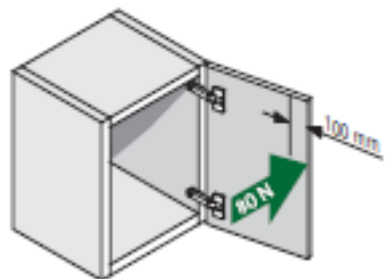

Test door

Weight approx. 5.2 kg

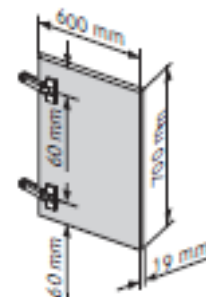

Salt spray and humidity test

Based on DIN ISO 9227 and DIN 6270-2

