

Concealed High Efficiency CAM Action Overhead Door Closer

24082

EN2-4 power adjustable by spring door closer



- Aluminium Extruded Body
- High performance CAM action mechanism
- 23mm wide Slide track with matching arm
- Adjustable closing power, speed and latch action
- Cushion Stop/Backcheck
- Mechanical Hold Open Device available *(Not suitable for use on fire doors)
- Fully reversible for use in door or transom fixing positions
- Minimum door thickness 44mm
- Intumescent packs available

Technical Data

 **Declaration of Performance:**
Available upon request

 **Certifire Certificate No.:**
CF 5293

 **Classification:**

3	8	4	1	1	3
---	---	---	---	---	---

CE Certificate No.:
1121-CPD-AD5192

Available Cover & Arm Finishes

Metallic Finishes



PCC

SES

SNP

RAL Colours available to Special Order

Fixing Instructions for : 24082 Door Closer Power Adjustable EN 2~4

 1121	Synergy Hardware Limited Lifford Lane, Kings Norton, Birmingham B30 3JN				CPR AD5192	14
BS EN1154:1997+A1:2002						APPROVED PRODUCT CF5293
3	8	4 2	1	1		

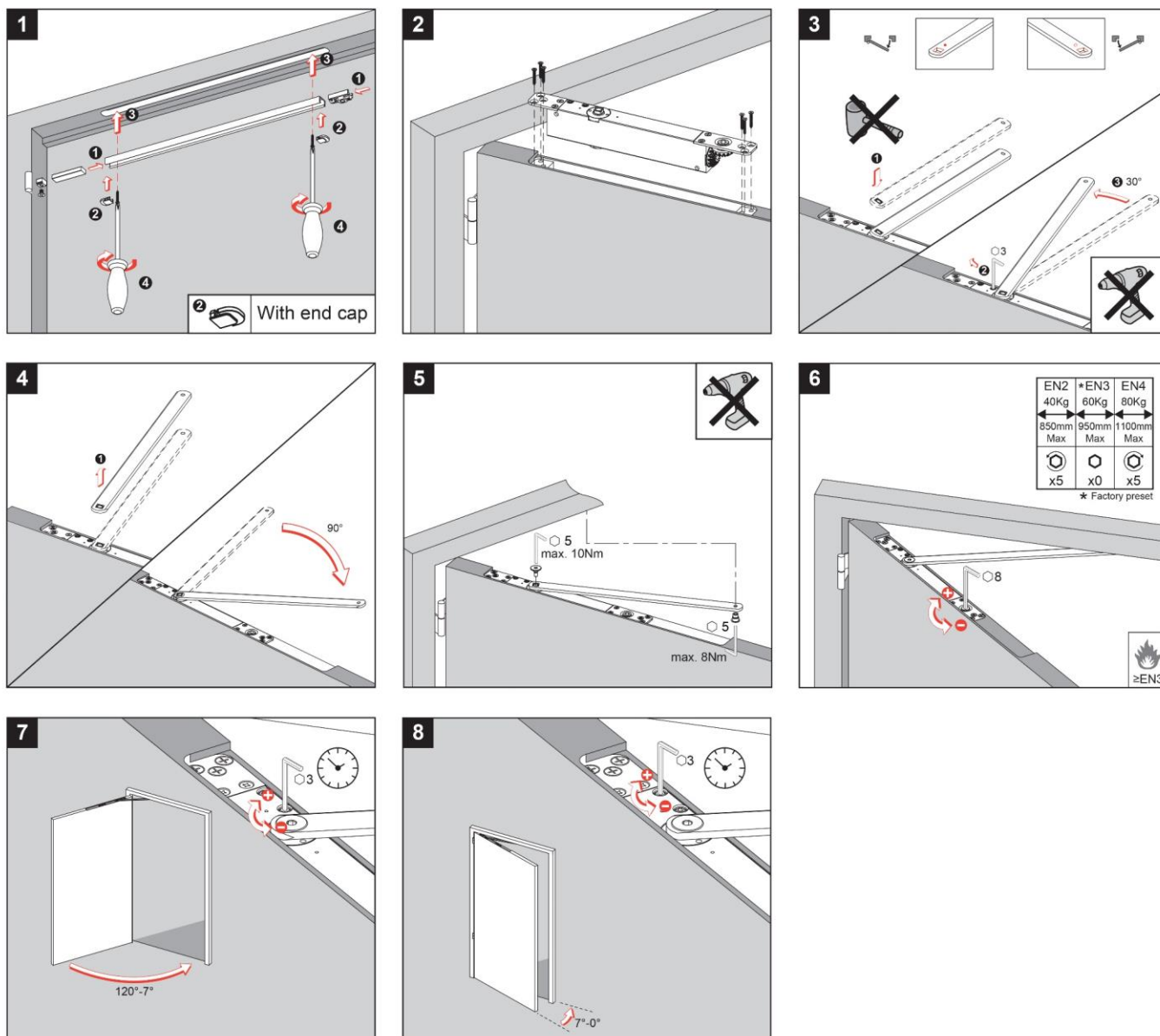

Installation and Maintenance Instructions:

Warning



- Please note the minimum power size requirement for fire / smoke door assemblies is 3 as required by Approved Document B.
- Do not install mechanical hold open devices on fire / smoke door assemblies.
- Take care not to exceed the maximum opening angle as detailed above.
- Care and attention must be taken when adjusting any of the units control valves to avoid damage through over adjustment.
- All closer units are sealed for life and the internal components assembled under high load, therefore, tampering with the mechanism is to be strictly avoided.

After Installation



- When the closer operates to close the door from its maximum opening position, it should ensure the lock latchbolt and any seals are overcome and the leaf returned into its frame.
- When the door is slightly open and the latch bolt resting against the strike, release the door to ensure the leaf fully closes into its frame.
- It is recommended to fit door stops to prevent the door opening beyond its limits.

Maintenance



- Once the unit has been correctly fitted it is recommended that periodic checks (every six months) are carried out to ensure all fixings are tight and the door closes freely and positively into the frame, without slamming.
- A light oil lubricant (non-graphite) should be applied to the moving joints and exposed pivot points. Hinges should be maintained in accordance with the manufacturer's instructions.

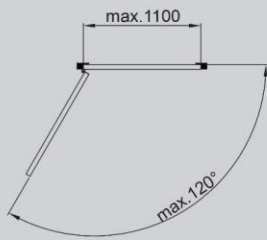
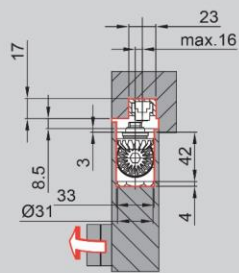

440 & 145
Illustration shows without end cap.
(464)&(133)
Illustration shows with end cap.

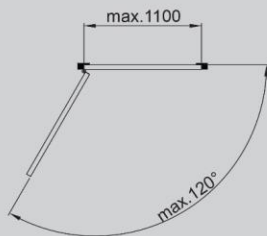
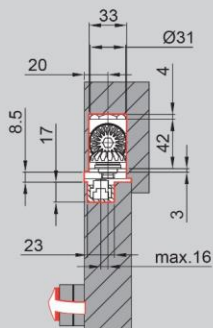
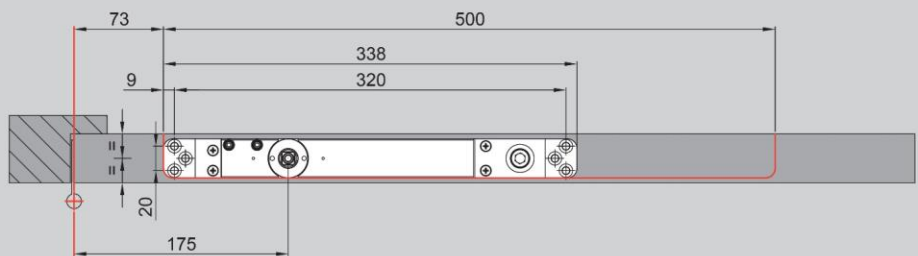
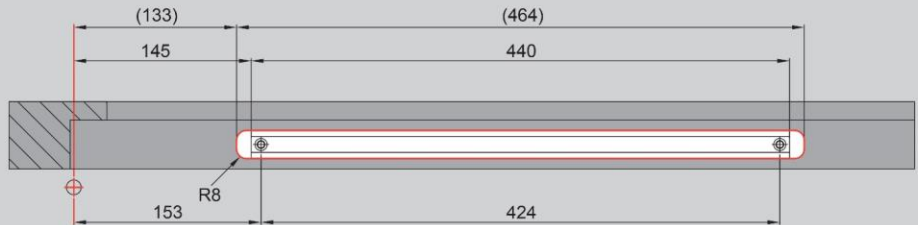
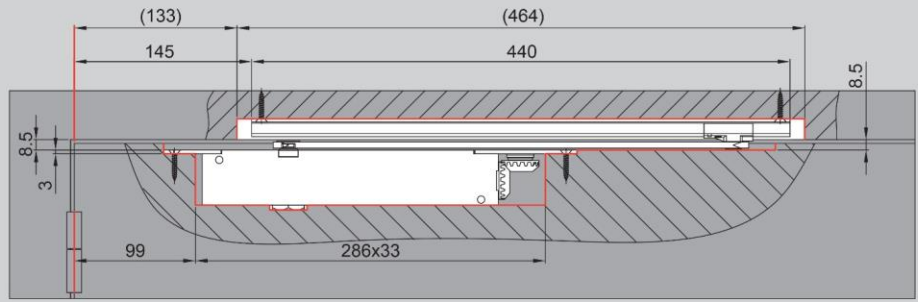

440 & 145
Illustration shows without end cap.
(464)&(133)
Illustration shows with end cap.

