

## Watch the Installation Video

Visit [www.pchenderson.com/pocket-door-pro-installation](http://www.pchenderson.com/pocket-door-pro-installation) or scan the QR code using your phone

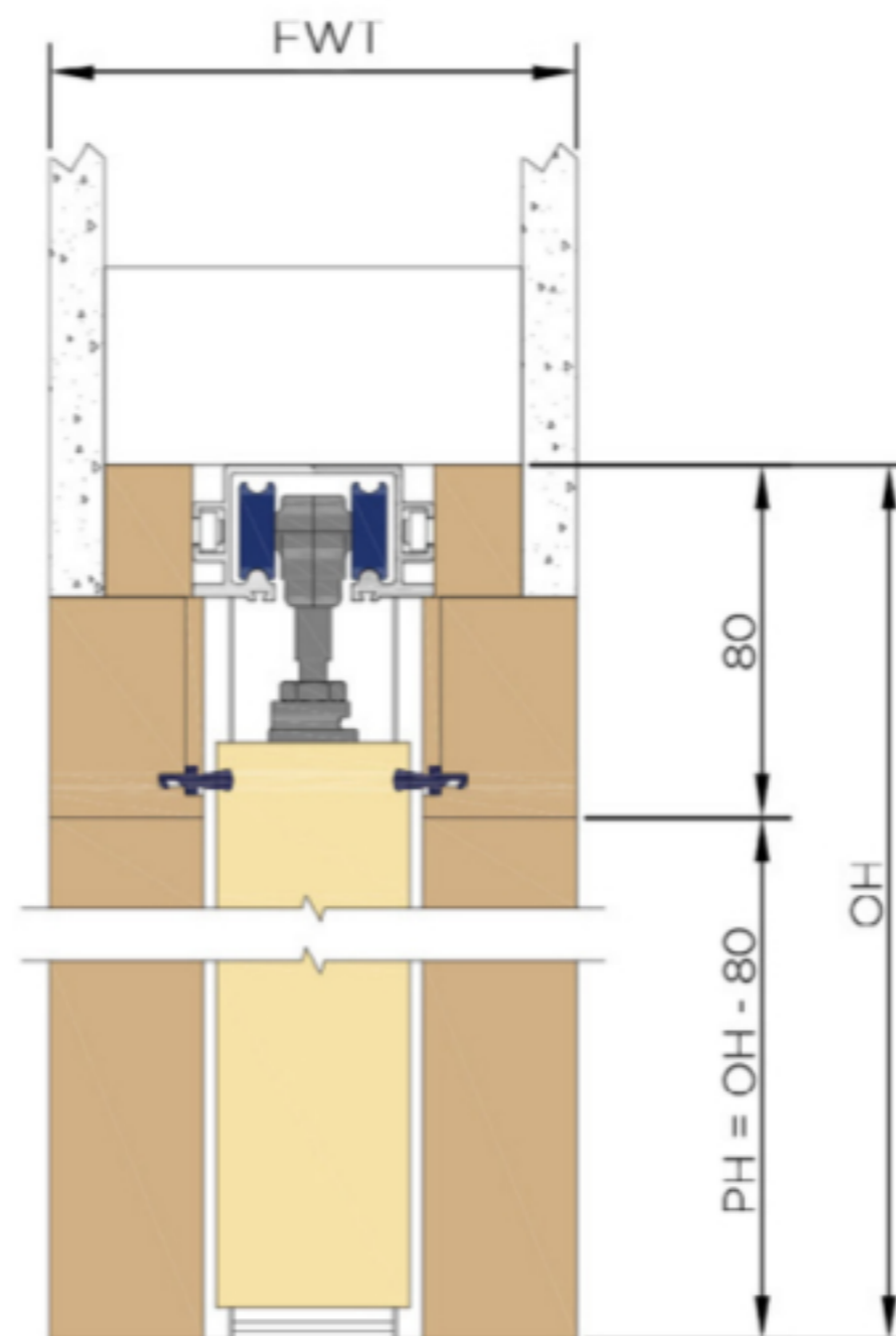
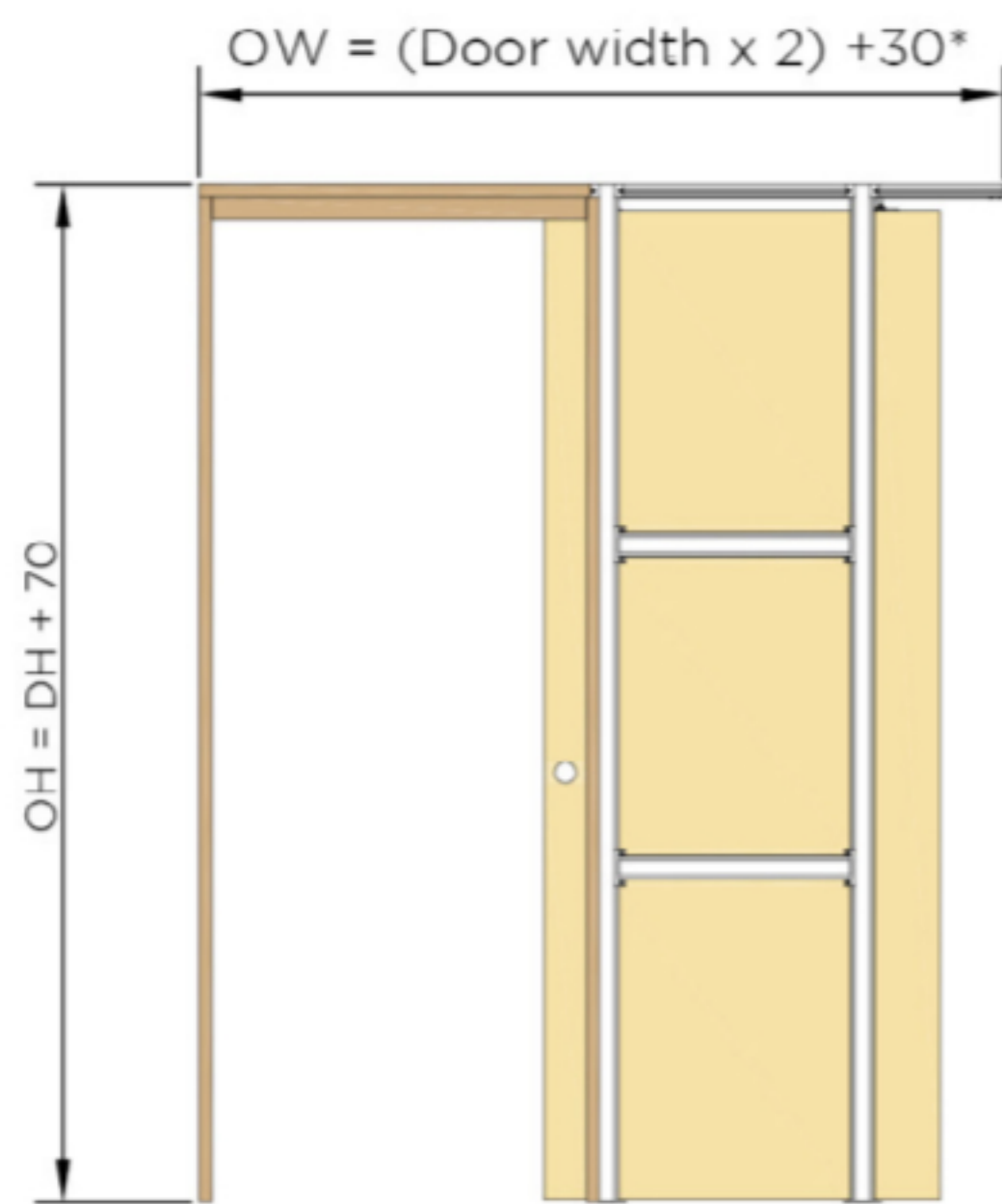
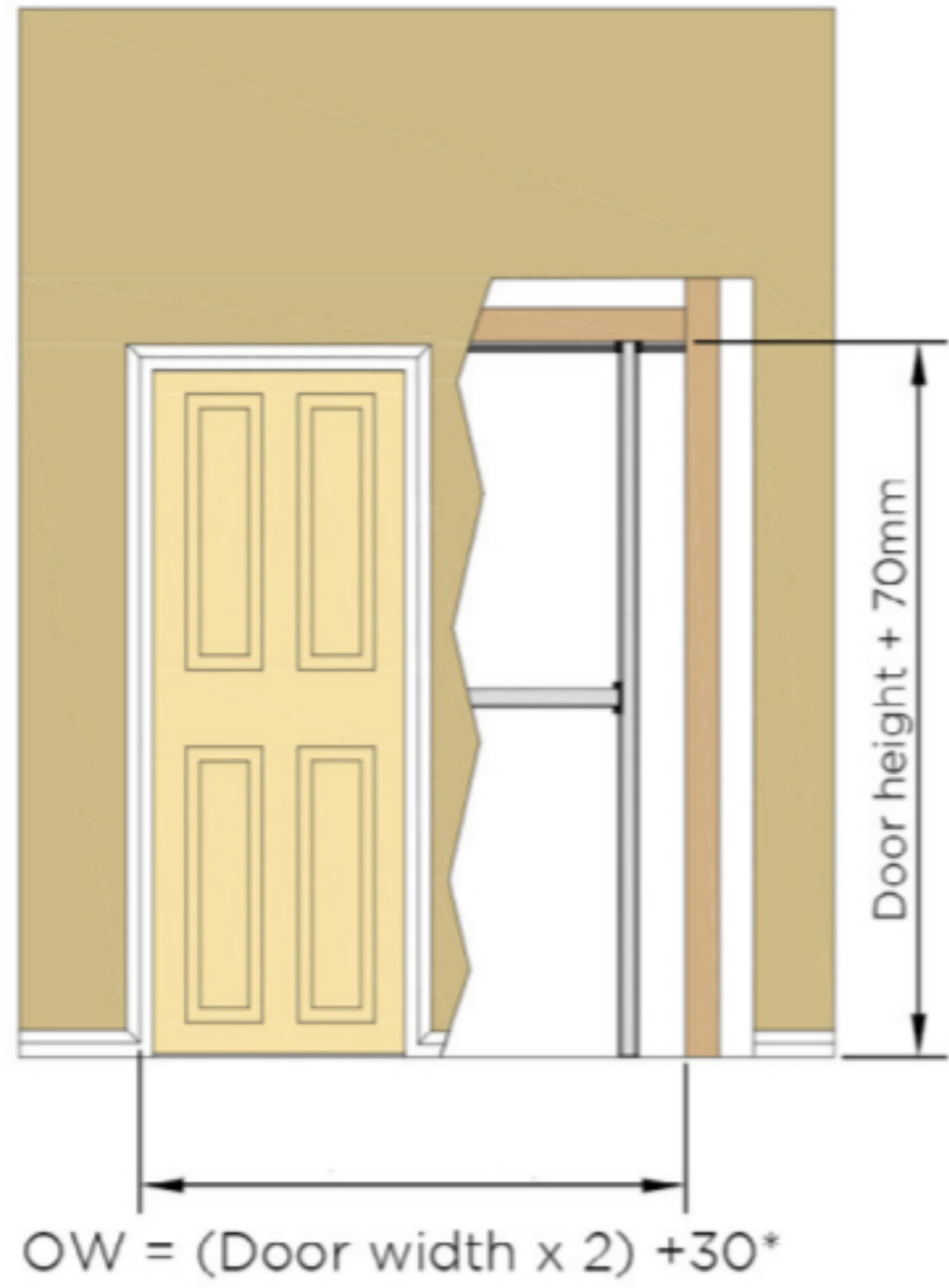

## Finished Wall Thickness Calculation

125mm Finished Wall Thickness

100mm cavity + 12.5mm plasterboard either side = 125mm finished wall thickness

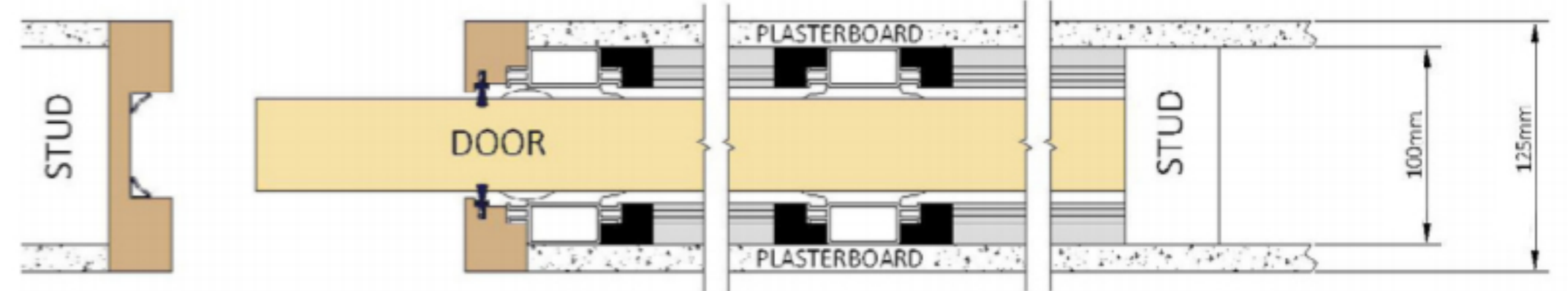

Floor guide & bracket

## For Biparting Doors

$$PW = (2 \times DW) - 50$$

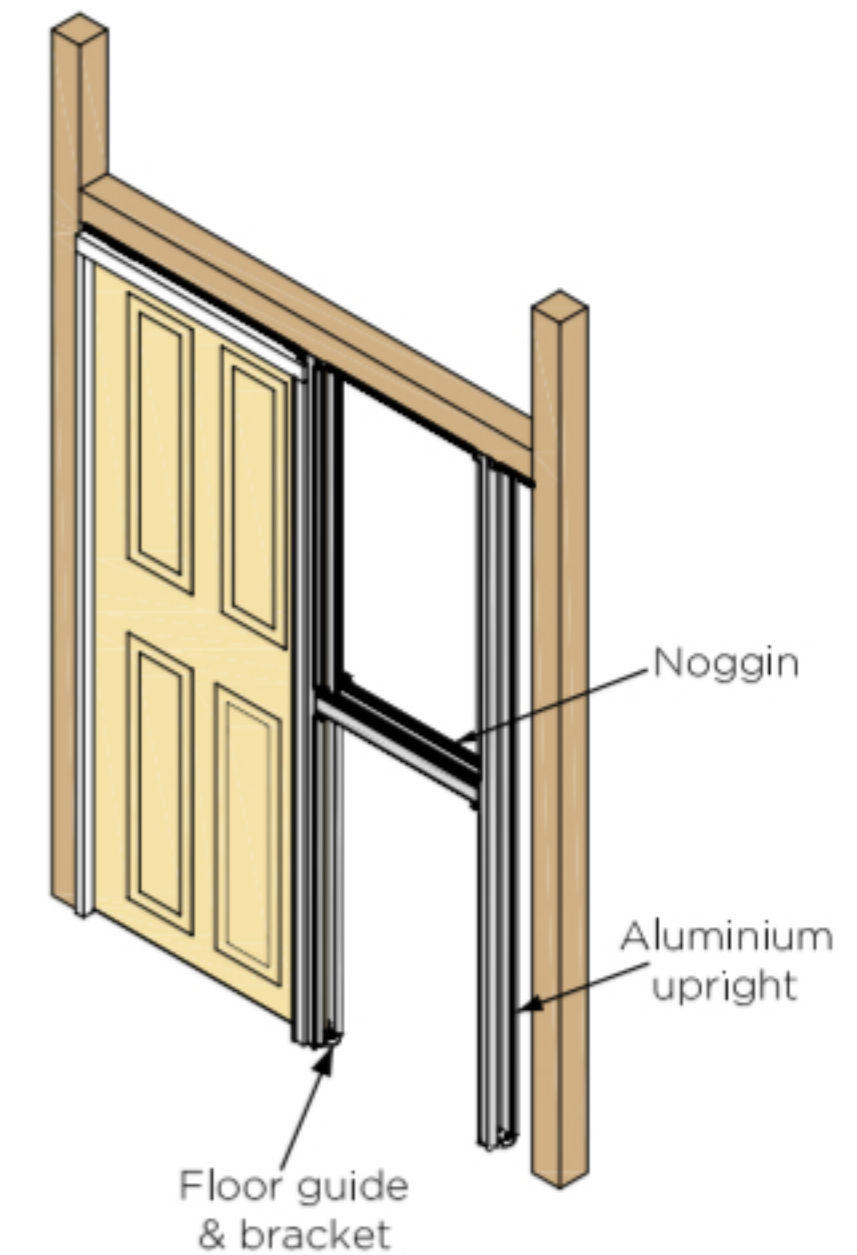

## Key

OW	Overall width
OH	Overall height
DH	Door height
DW	Door width
PH	Opening height
PW	Opening width
FWT	Finished wall thickness

\* If using a self close system, this dimension changes to 62mm.