

saheco

Nov 2012

SF-A84D

3-4 Hojas / Sheets / Feuilles

Poligono Industrial Foradada - 08580 - Sant Quirze de Besora (Barcelona)

Telf. 34-93.852.92.23, Fax.34-93.852.91.59

Export. Telf. 34-93.852.96.15, Fax.34-93.852.91.76

e-mail: saheco@saheco.com

web: www.saheco.com

**GRUPO
TORREMAT**

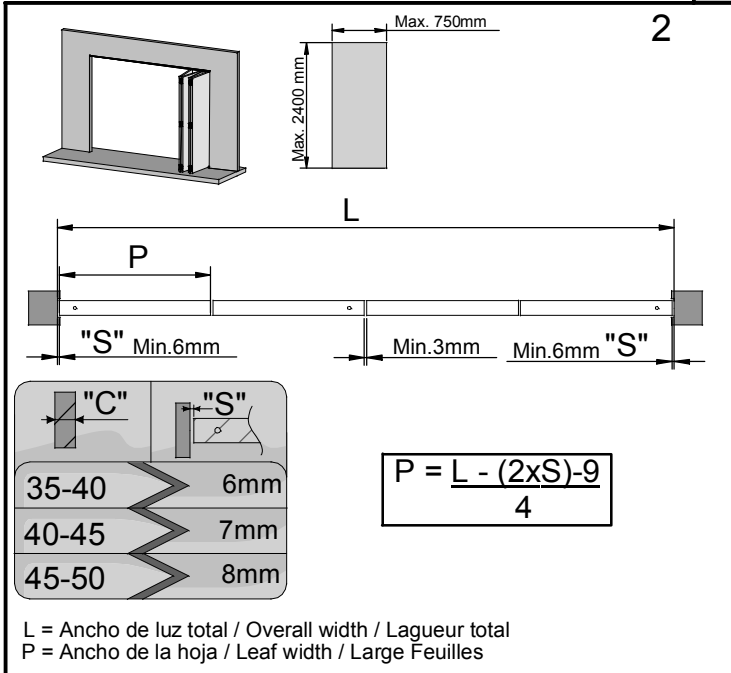
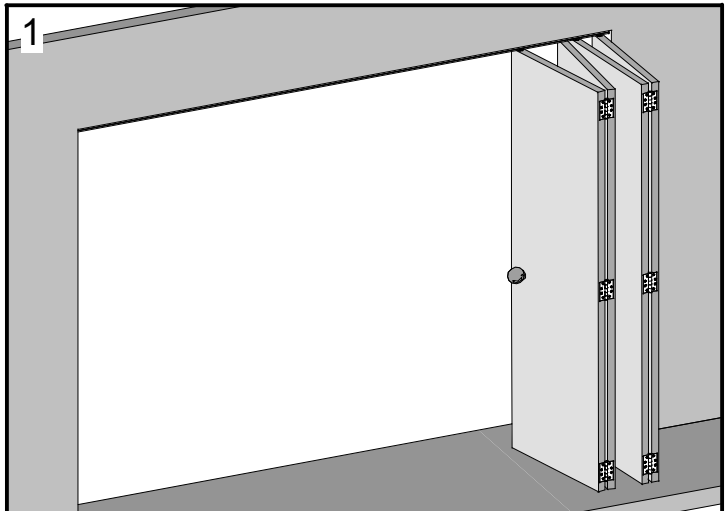
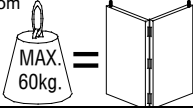

Contenido del juego Content of the set Contenu de l'ensemble

Ref. 00 88 01			2x Ref. 00 88 02		
z		1	s		2
y		1	r		2
x		1	v		4
w		1	p		2
v		4	m		1
u		2	n		2
vt		2	p		1
			t		1

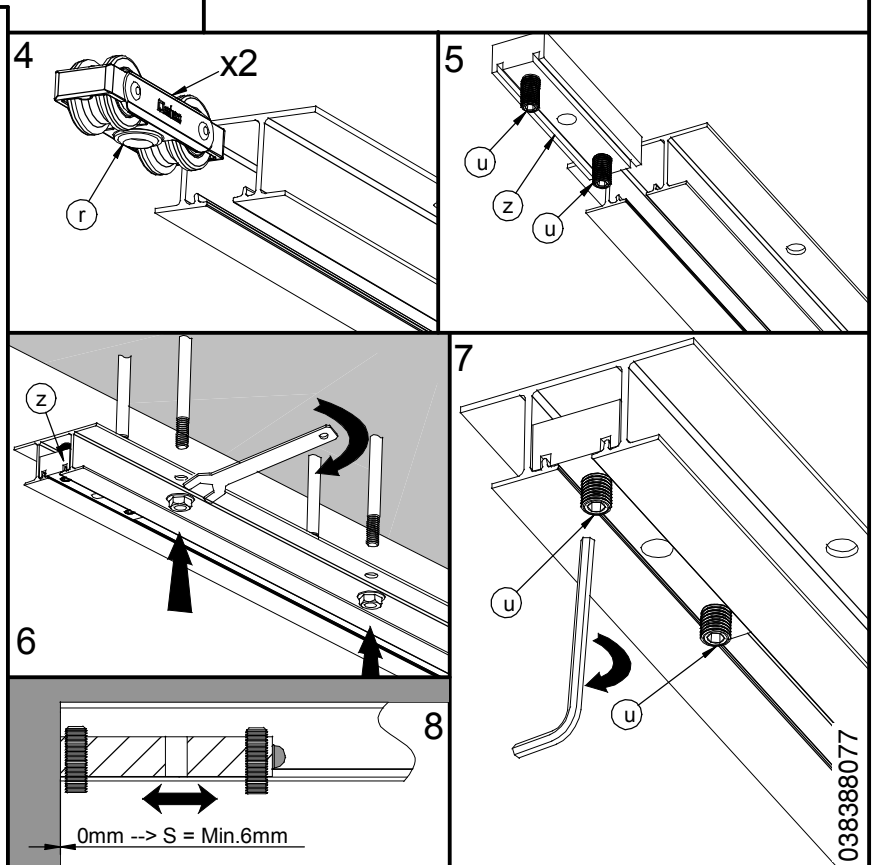
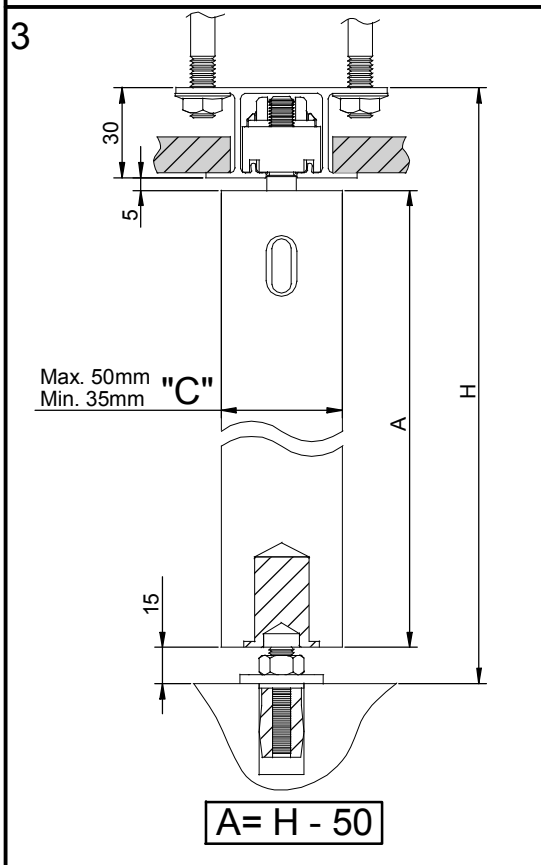

Made in Spain

Mecanizados hoja batiente
 Swing Sheet mechanization
 Mécanisés panneau battante

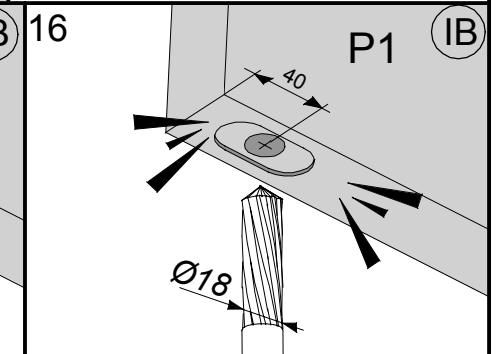
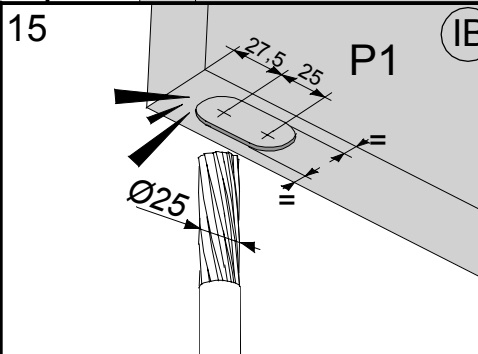
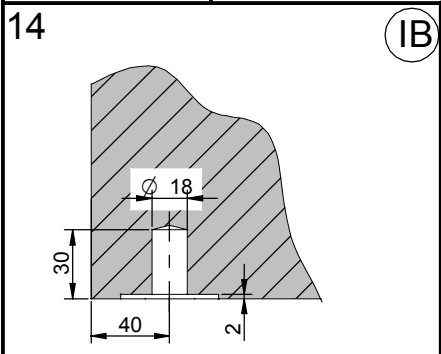
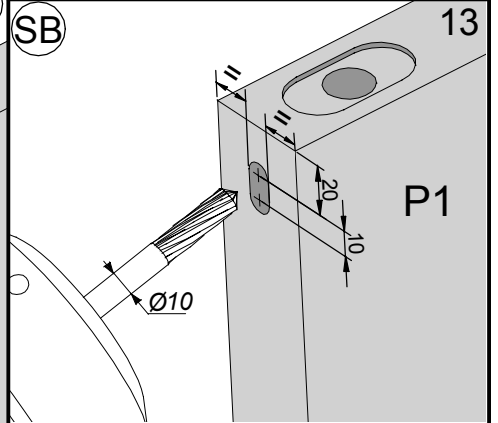
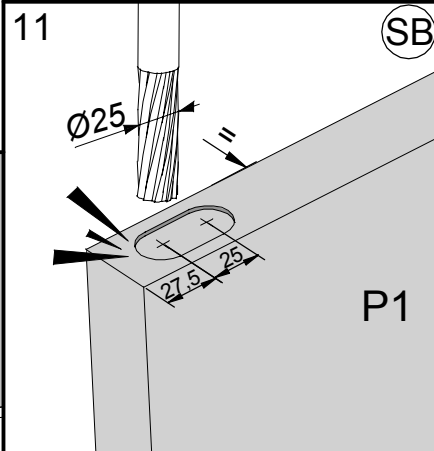
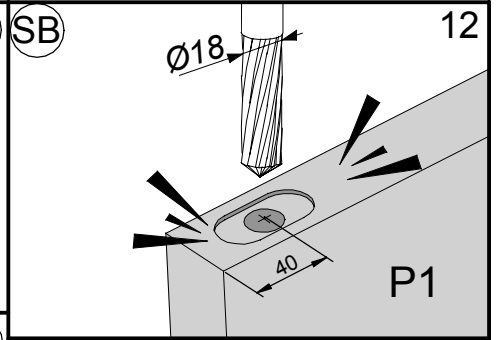
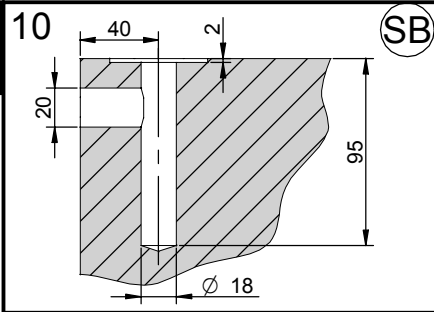
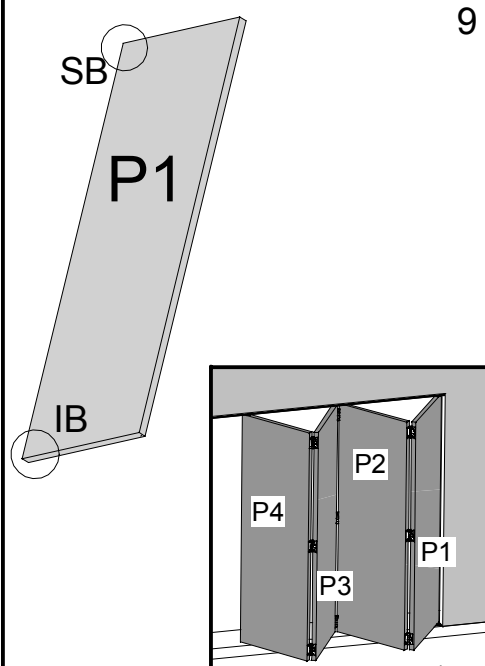

Mecanizado hoja 2 y hoja Final
 Mechanization of 2nd sheet & final sheet
 Mécanisation de panneau 2 et panneau finale

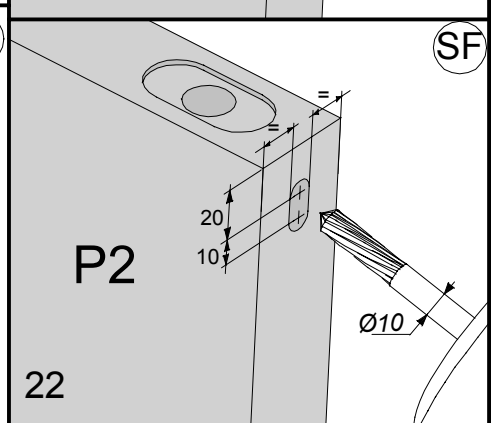
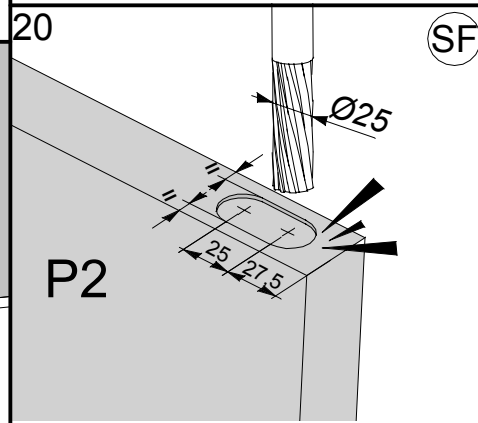
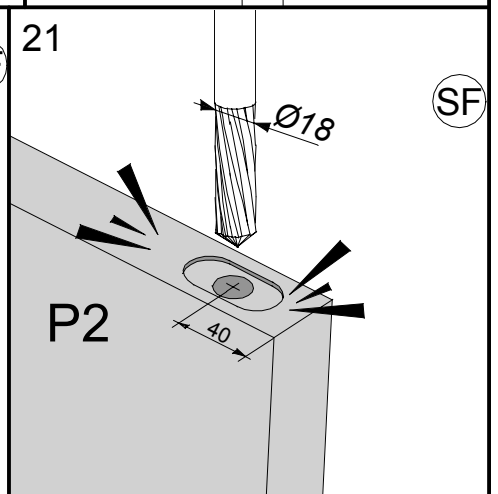
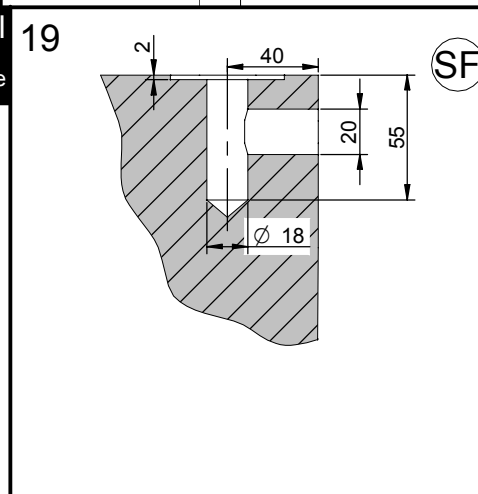
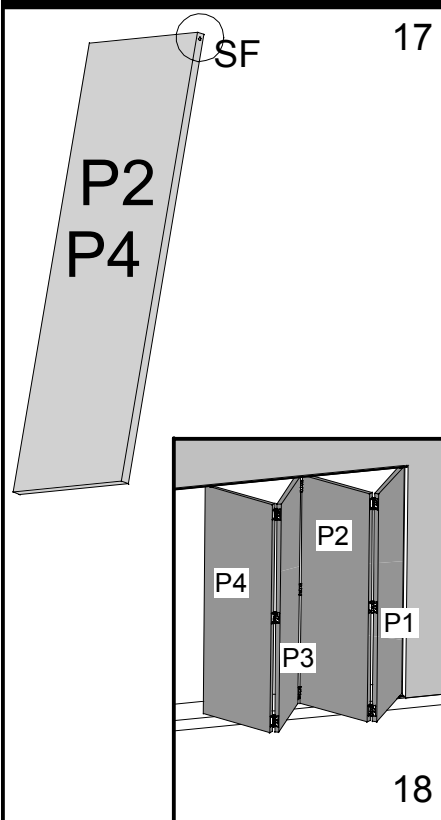

Mecanizado Soporte Inferior
 Mechanization of Lower support
 Mécanisation du Support inférieur

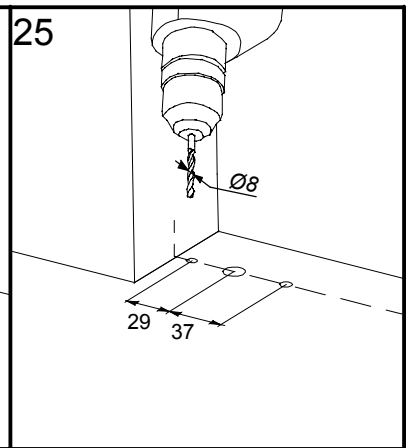
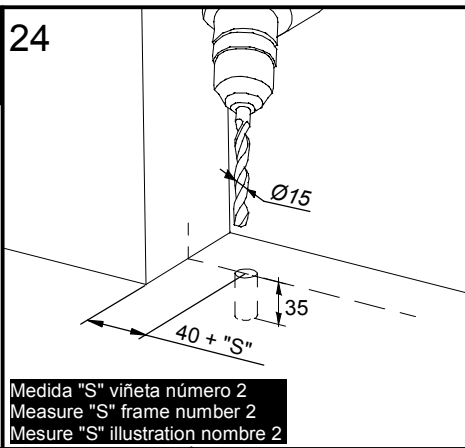
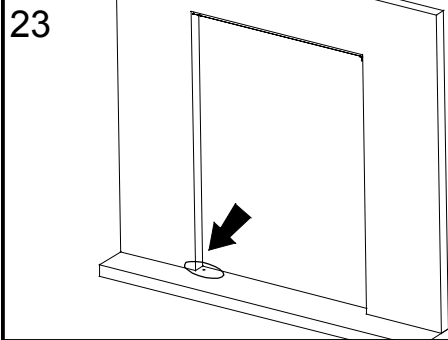

Medida "S" viñeta número 2
 Measure "S" frame number 2
 Mesure "S" illustration nombre 2

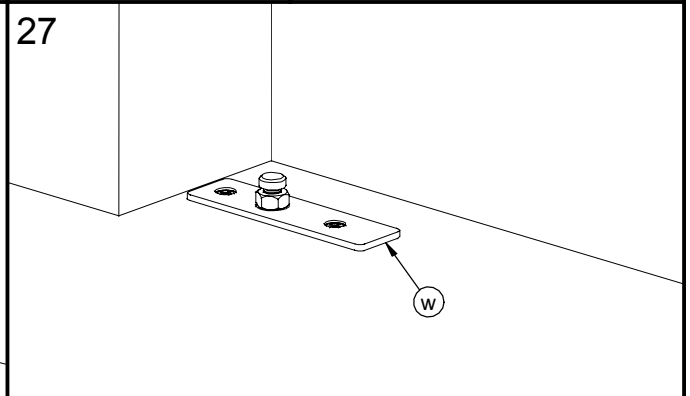
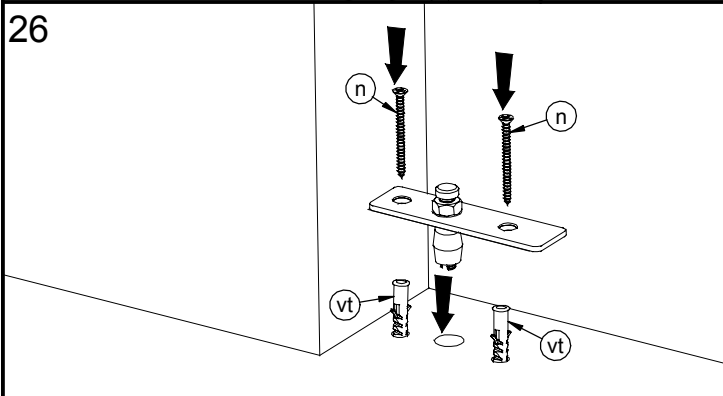

Montajes Hojas
 Sheet assembly
 Assemblage des panneaux

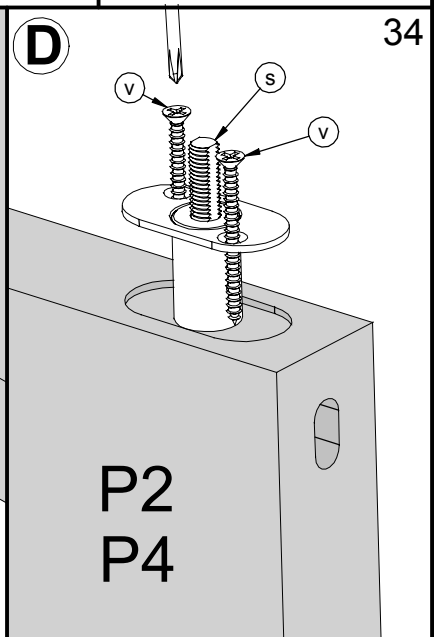
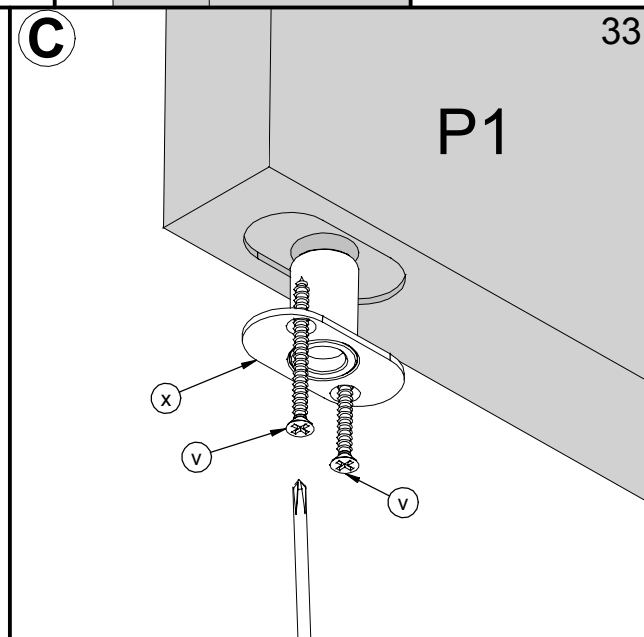
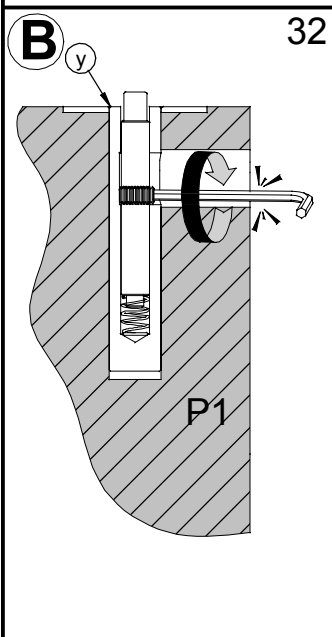
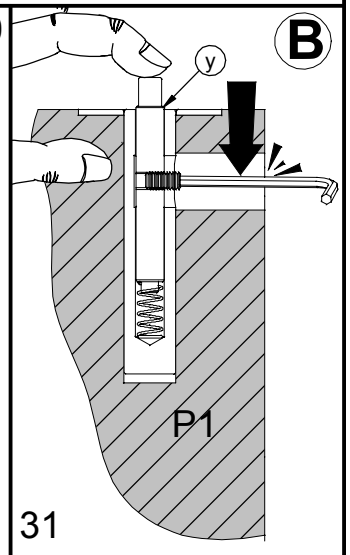
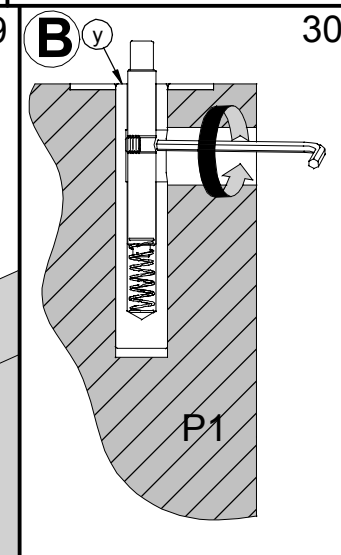
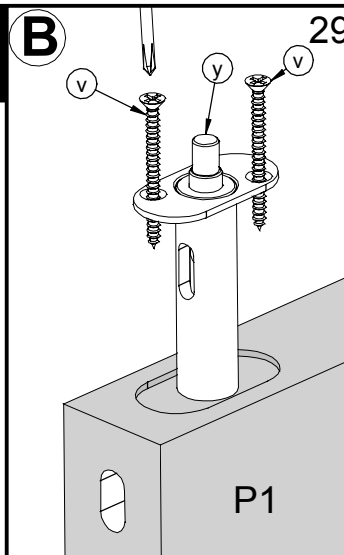
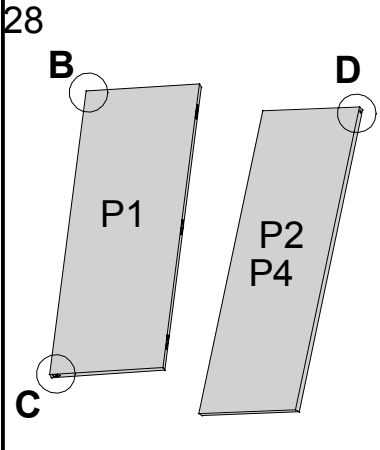

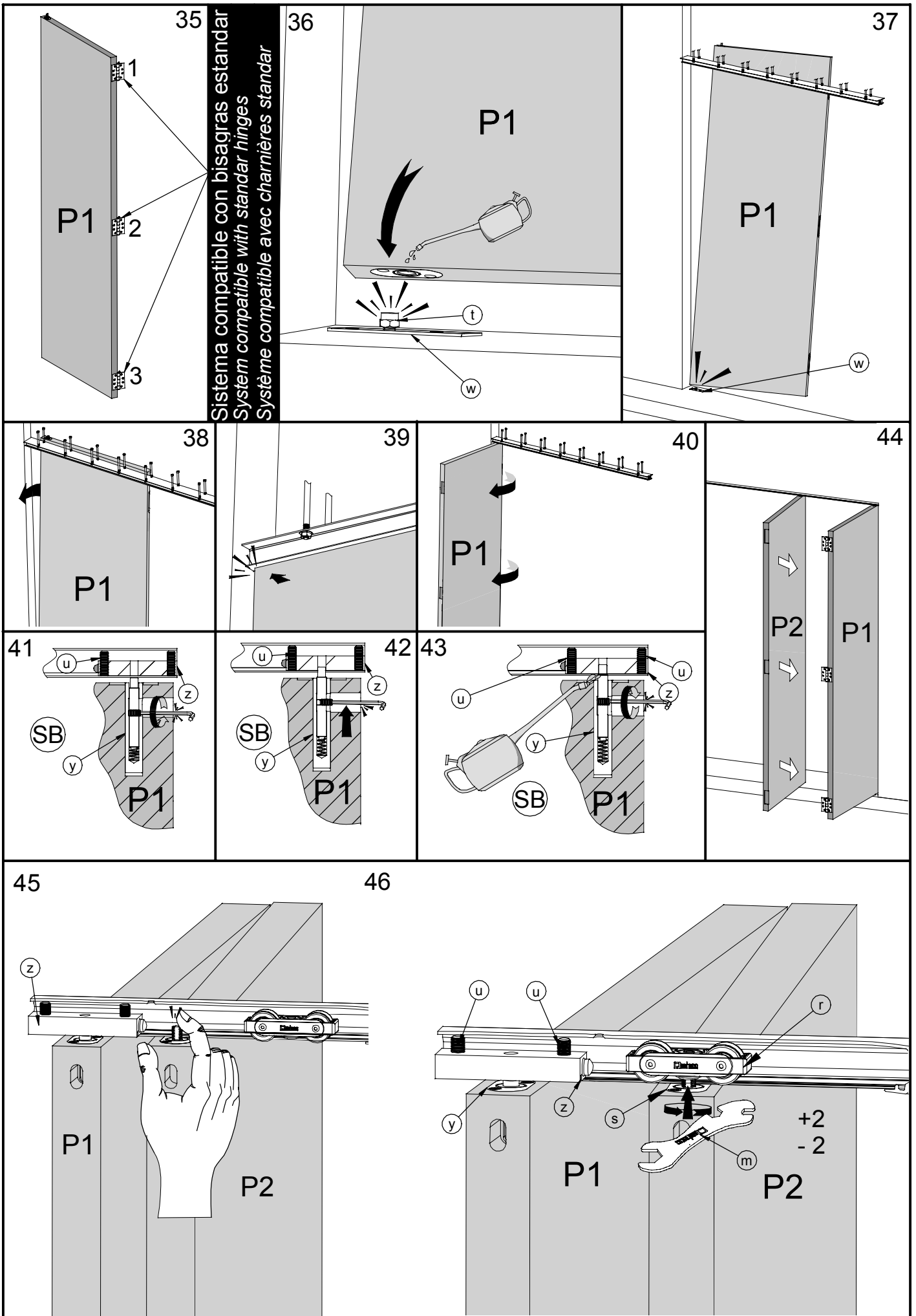

Sistema compatible con bisagras estandar
 System compatible with standar hinges
 Système compatible avec charnières standar

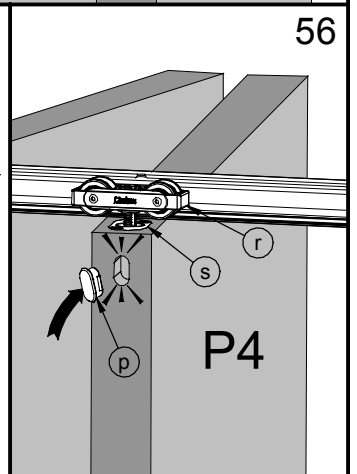
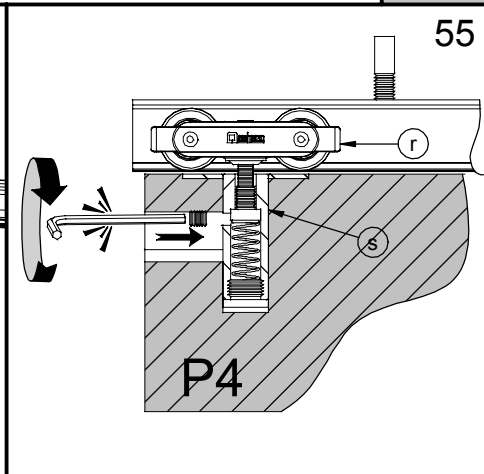
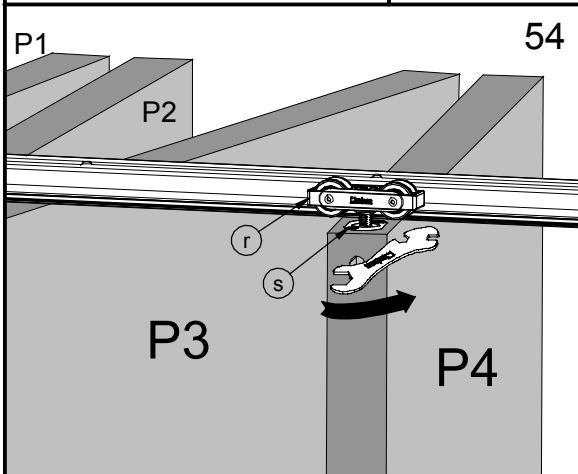
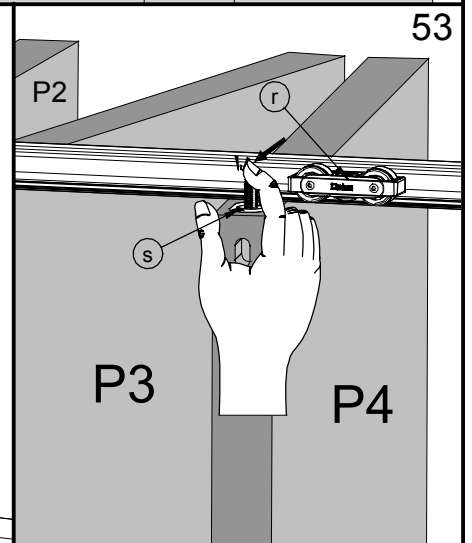
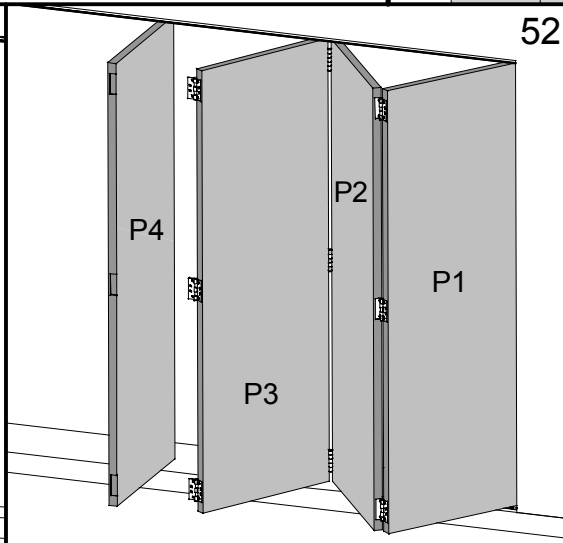
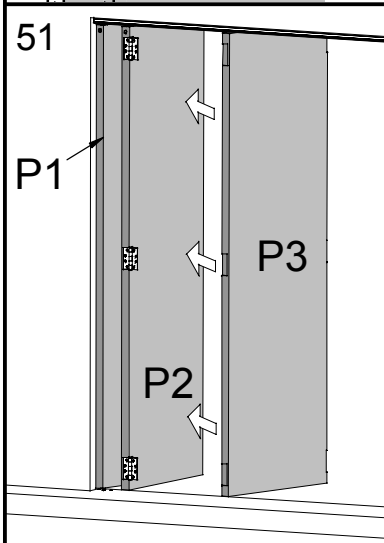
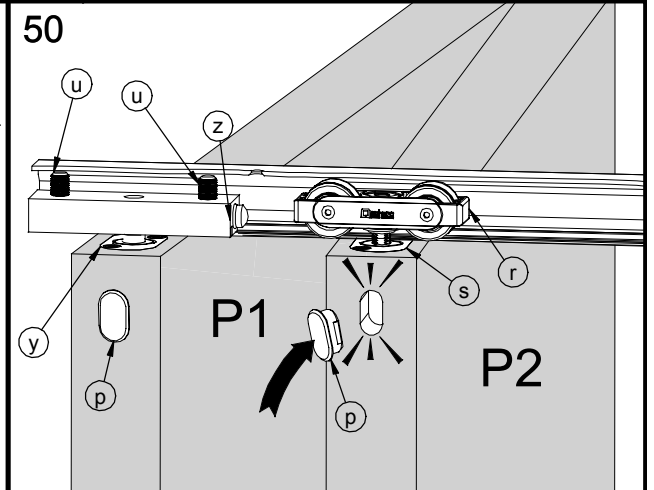
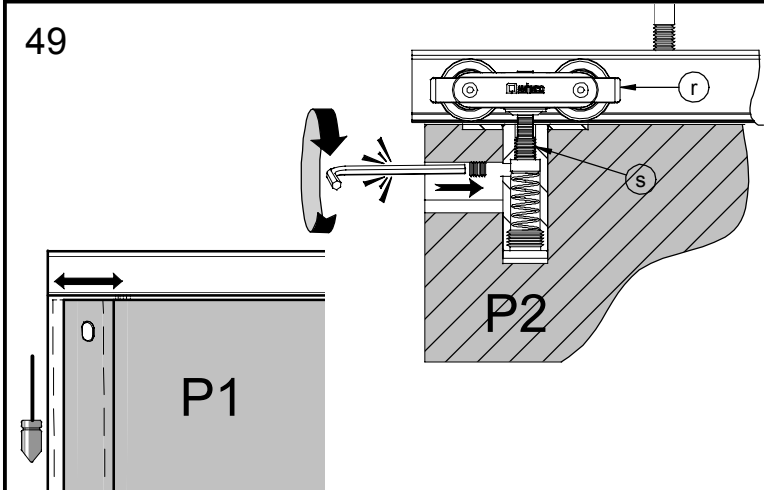
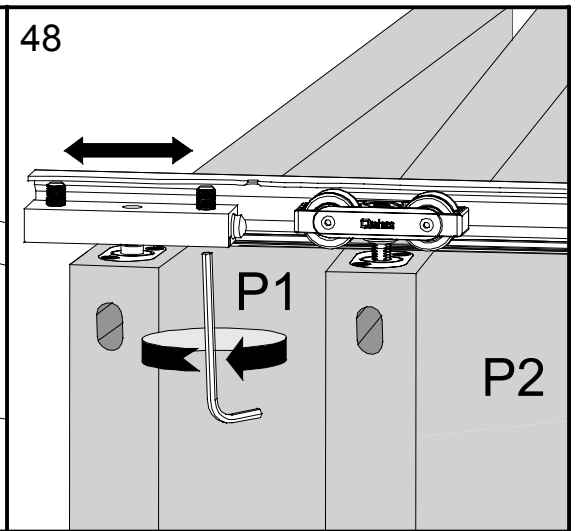
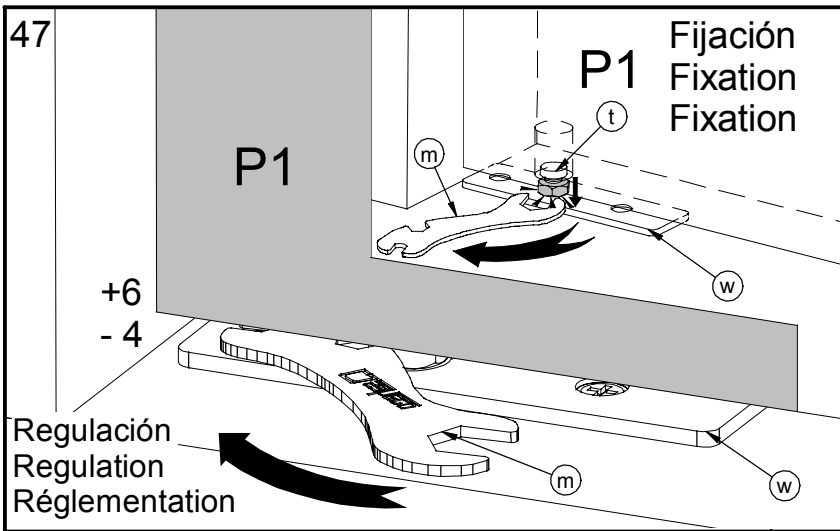

57

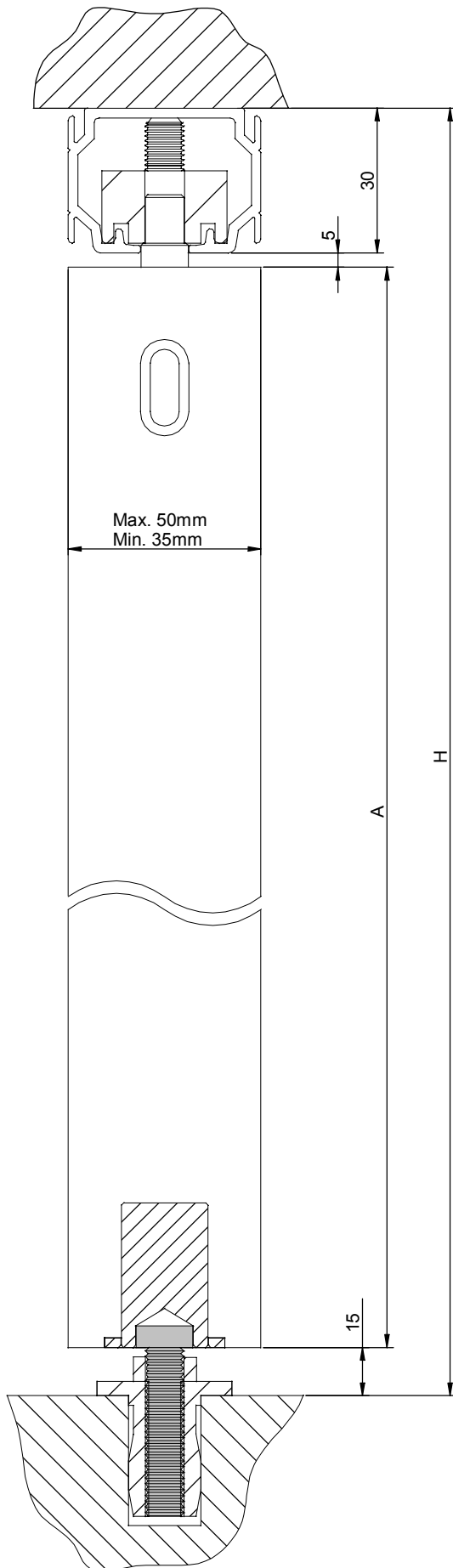

$$A = H - 50$$

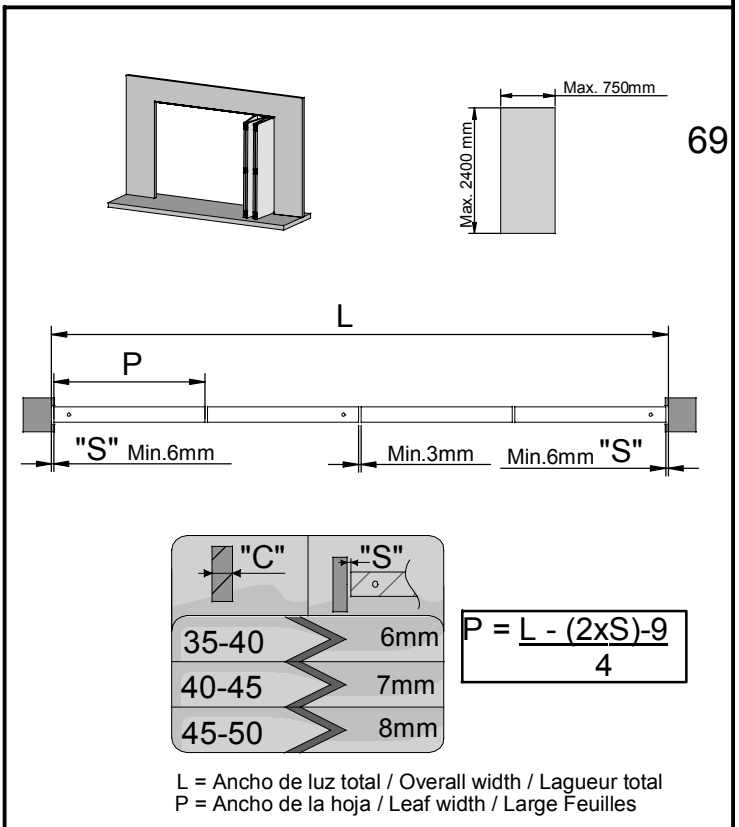

69

VARIANTES DE INSTALACIÓN

INSTALLATION VARIANTS
VARIANTS DE MONTAGE

35-40	6mm
40-45	7mm
45-50	8mm

FORMULARIOS PARA SISTEMAS

SYSTEMS FORMULARYS
FORMULAIRES POUR SYSTÈMES

	 	Max. 750mm	$P = \frac{L - (2xS) - (2xD)}{3}$
	 	Max. 1000mm	$P = \frac{L - (2xS) - D - F}{3}$
	 	Max. 750mm	$P = \frac{L - (2xS) - (2xD) - F}{4}$
	 	Max. 750mm	$P = \frac{L - (2xS) - (3xD) - F}{5}$
	 	Max. 750mm	$P = \frac{L - (2xS) - (4xD) - F}{6}$
	 	Max. 750mm	$P = \frac{L - (2xS) - (3xD)}{4}$
	 	Max. 750mm	$P = \frac{L - (2xS) - (3xD) - F}{5}$
	 	Max. 750mm	$P = \frac{L - (2xS) - (4xD) - F}{6}$
	 	Max. 750mm	$P = \frac{L - (2xS) - (5xD) - F}{7}$
	 	Max. 750mm	$P = \frac{L - (2xS) - (6xD) - F}{8}$

L = Ancho de luz total / Overall width / Largeur total
 P = Ancho de la hoja / Leaf width / Large Feuilles
 F = Franquicia central / Central Gap / Franchise central
 D = Separación bisagras / Hinges Separation / Separation charniere
 S = Franquicia inicial / Initial Gap / Franchise initiale

Ejemplo / Example / Exemple:

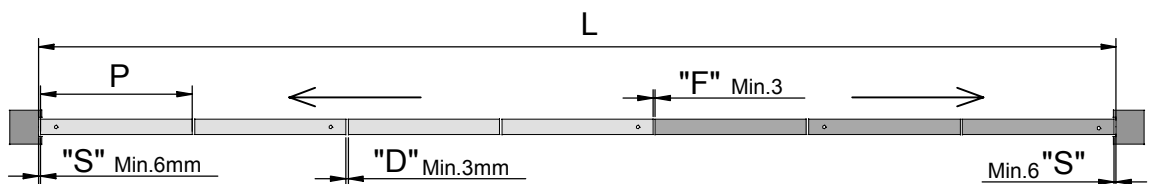

VARIANTES DE INSTALACIÓN
INSTALLATION VARIANTS
VARIANTS DE MONTAGE

* Variante con guidor inferior / Variant with lower guide / Variant avec guide inferieur

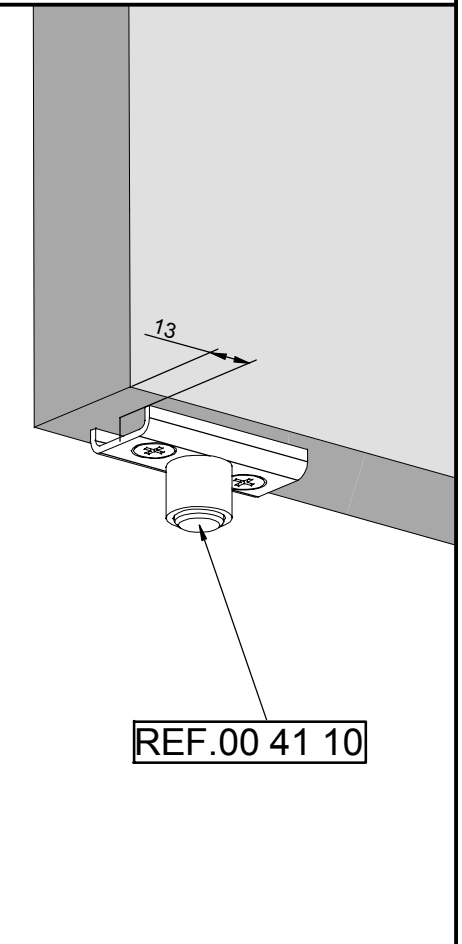
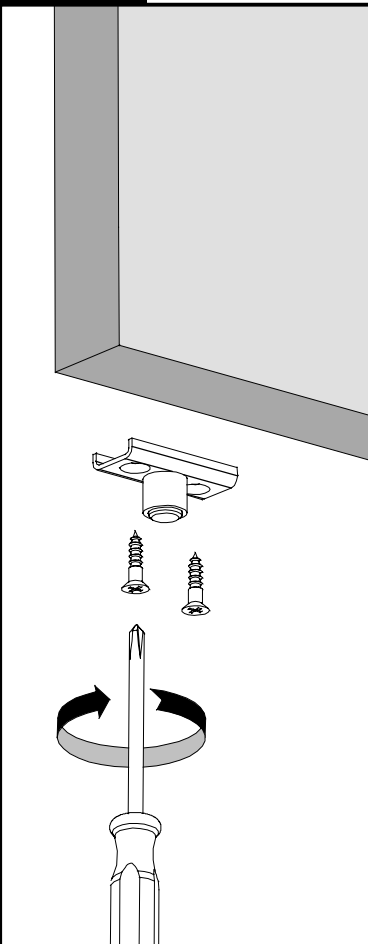
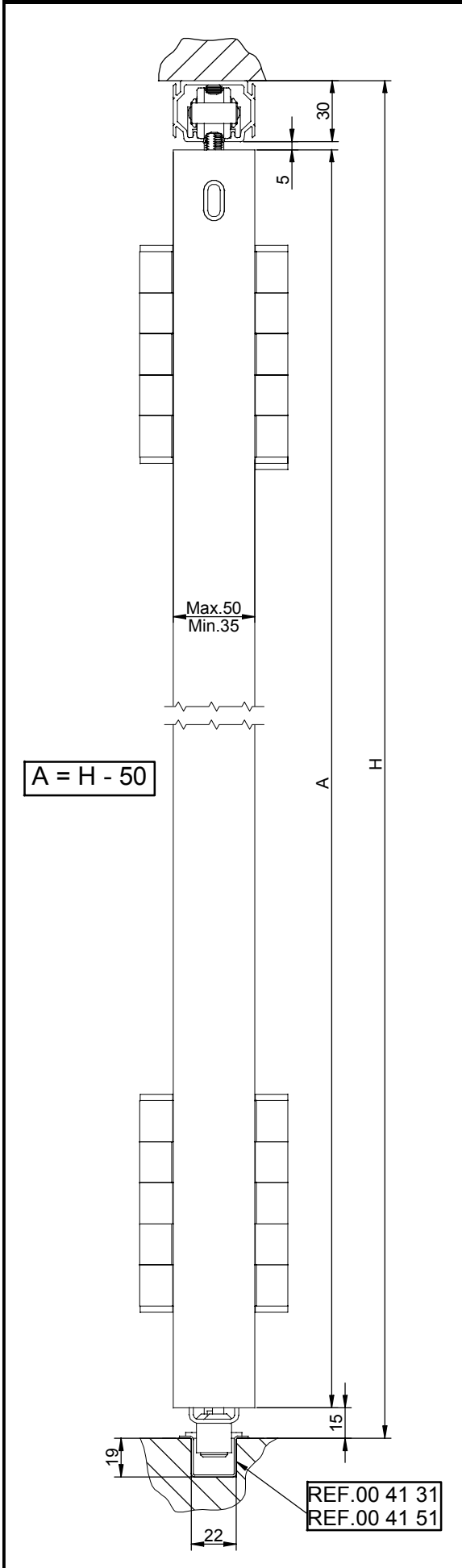

Diagram showing door dimensions and hinge specifications. It includes a table for hinge types, a weight limit, and a formula for calculating the leaf width 'P'.

"C"	"S"
35-40	6mm
40-45	7mm
45-50	8mm

MAX. 80kg. =

Max. 2400 mm
Max. 750mm

$$P = \frac{L - (2 \times S) - (3 \times D)}{4}$$

L = Ancho de luz total / Overall width / Largeur total
P = Ancho de la hoja / Leaf width / Large Feuilles
F = Franquicia central / Central Gap / Franchise central
D = Separación bisagras / Hinges Separation / Separation charniere
S = Franquicia inicial / Initial Gap / Franchise initiale